



L.U.D. of
Grunthal

2025
Service Plan &
Community
Projects

Introductions

Grunthal Local Urban District Committee:

- Anita Funk – Chairperson (204) 371-9134
- Paul Perreault (204) 371-6665
- Tom Guenther (204) 392-9216
- Curtis Dawydiuk Ward 6 Councillor

Luc Lahaie, CAO
RM of Hanover

Agenda



- ▶ 2025 Service Plan
- ▶ 2025 Capital and Construction Projects
- ▶ 2024 Completed Projects
- ▶ Hanover and Grunthal Recreation
- ▶ Grunthal Community Groups
(COPP, New Horizons, Food Bank, Lions Club, Hanover Ag)

Community's History



- ▶ Unincorporated Village District (UVD) of Grunthal was created in 1946.
- ▶ UVD changed to the Local Urban District of Grunthal in 1998 when the new Municipal Act came into effect.

LUD of Grunthal Expanded Boundaries

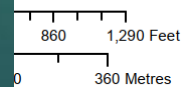
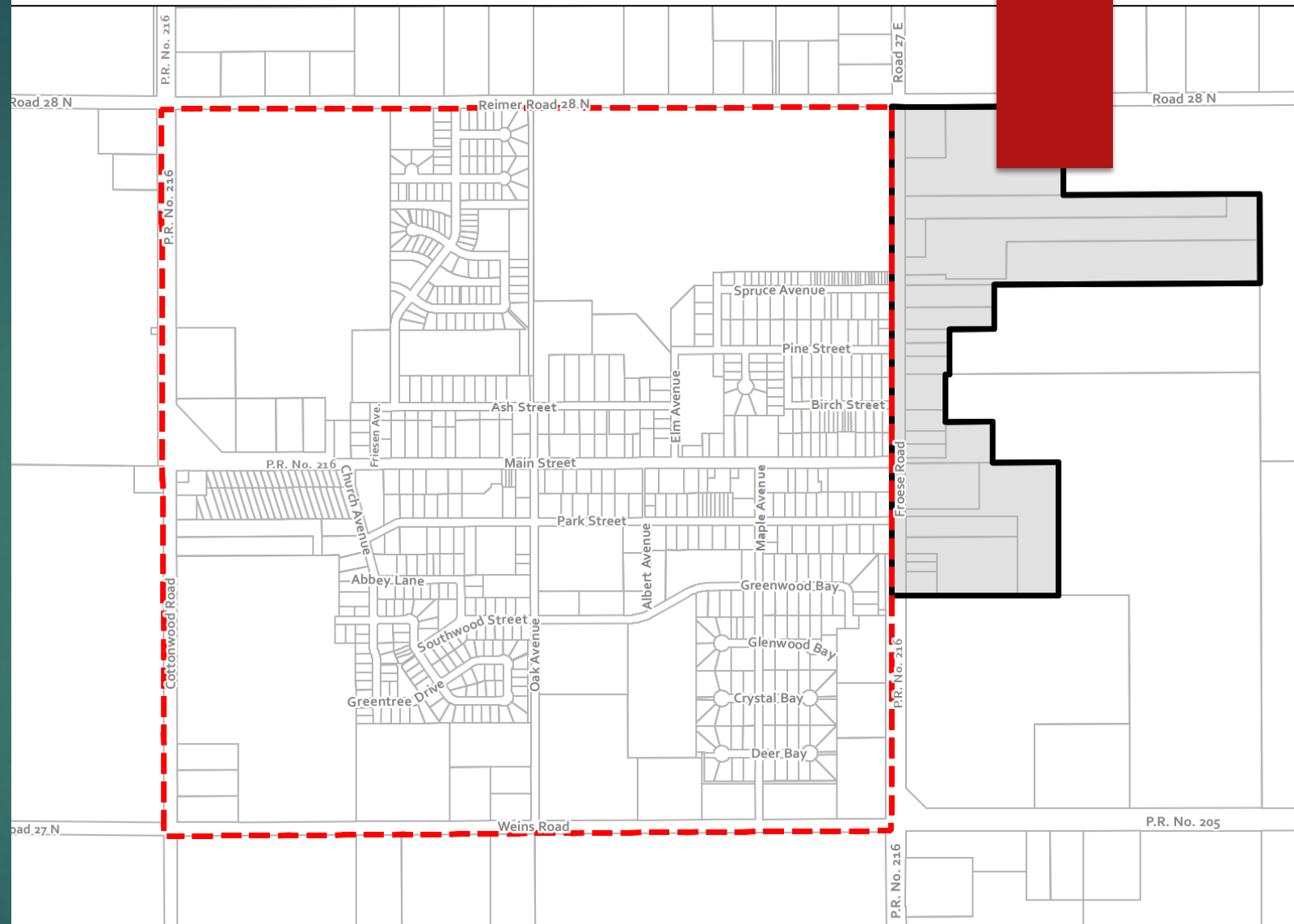

Local Urban District (L.U.D.) of Grunthal

In The R.M. of Hanover

Proposed Boundary

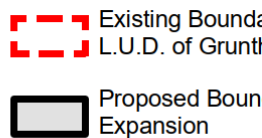

What's an LUD?

The RM is the local authority responsible for overall operation of the municipality

The LUD has been delegated certain duties:

- Road Maintenance (repairs, snow removal, street cleaning)
 - Drainage/Ditch Maintenance
 - Street Signage and Street Lighting
 - Sidewalk and Boulevard Maintenance (including mowing)
 - Composting and Solid Waste issue not provided by RM program
 - Weed Control
 - Public Parks Management (that's not overseen by recreation department)
-
- LUD sets service levels and annual mill rate for the community
 - LUD is not responsible for planning issues (zoning, CUs, variations and subdivisions)
 - Council and Administration works closely with the LUD Committee on all areas that impact residents

2025 Service Plan



- ▶ The LUD will be raising \$358,430 this year, down from \$361,391 in 2024.
- ▶ Mill rate is being reduced to 4.173 mills, down from the rate of 5 mills raised in 2024.

Grunthal's overall total municipal taxes (At-large and LUD rates) will rise slightly.

Tax Comparison - \$350,000 Residential Property

Assessment adjusted for 20.2% average increase in assessment, \$420,700

Excludes solid waste fees and utility fees

Area	2024	2025	Change	% of Change
Mitchell	1,612	1,583	(29)	(1.80%)
Grunthal	1,981	2,137	156	7.87%
Blumenort	1,116	1,278	162	14.51%
New Bothwell	1,727	1,841	114	6.60%
Kleefeld	1,613	1,687	74	4.59%
Rural	1,570	1,698	128	8.15%

LUD of Grunthal

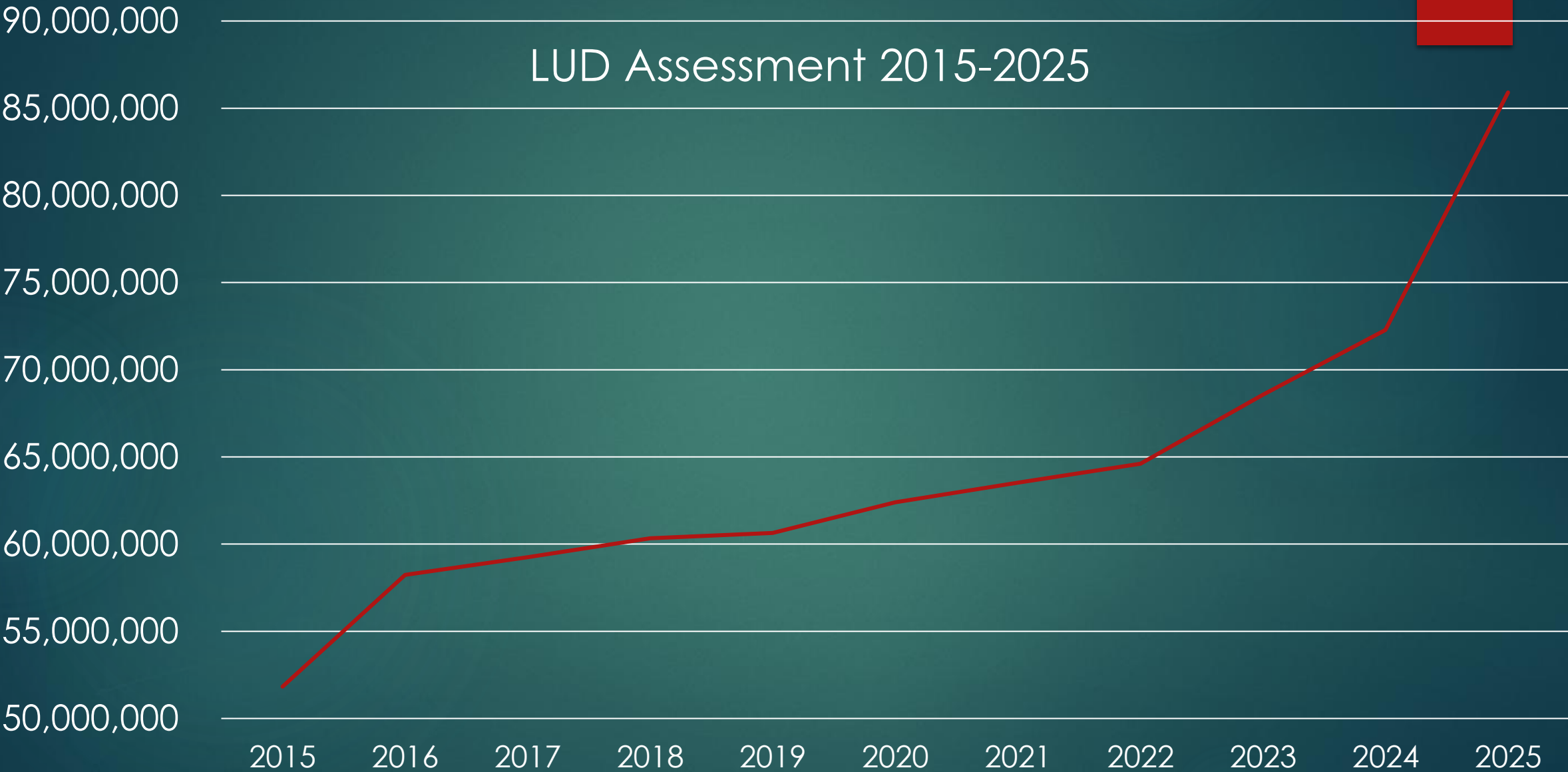

LUD Taxes Raised 2015-2025

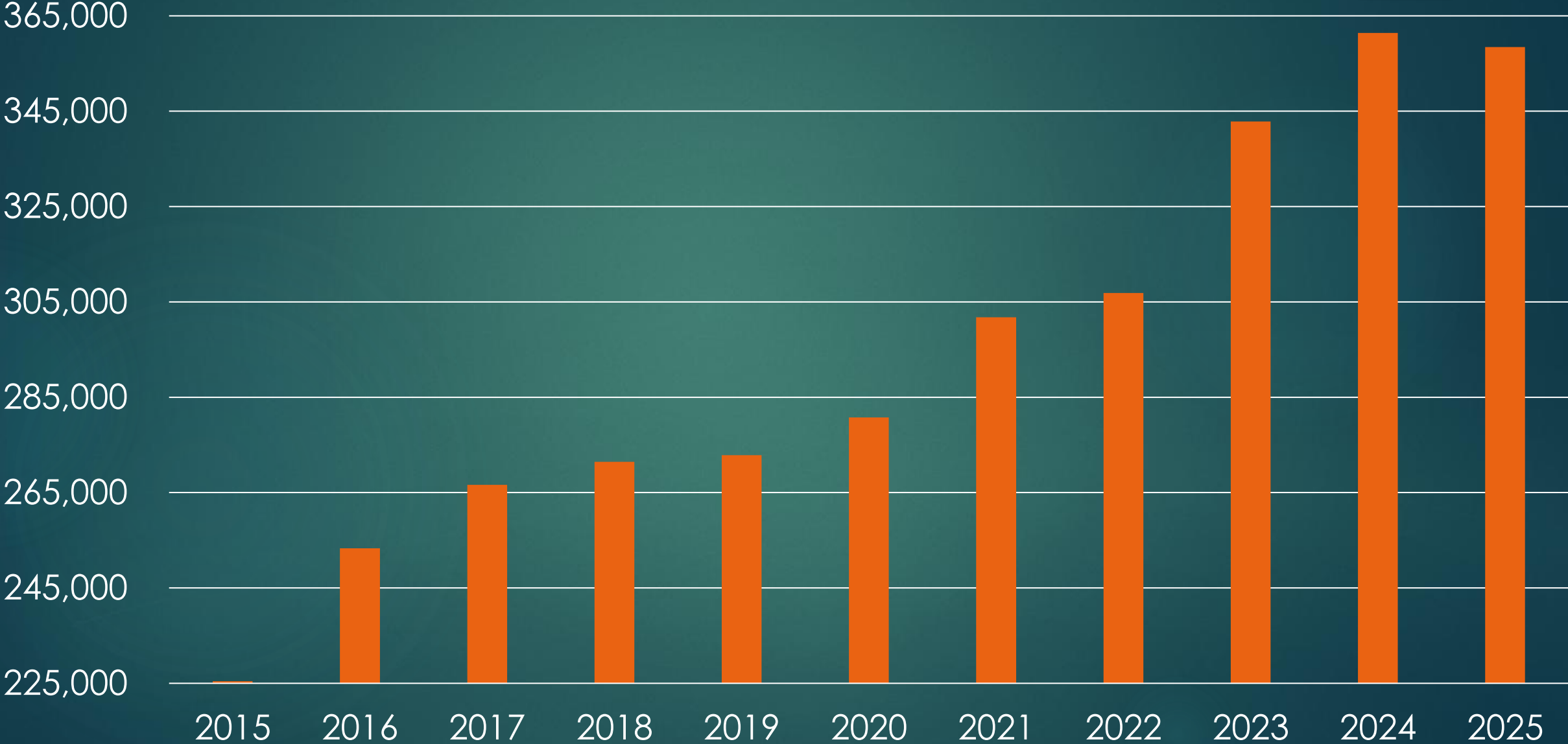

2025 Service Plan



General Government - \$39,532

- ▶ Legislative - \$27,782
- ▶ Grants - \$11,750

Environmental Health - \$1,558

- ▶ Supplemental composting services - \$1,558

Environmental Development Services - \$318

- ▶ Public Space Weed Control - \$318

Recreation and Cultural Services - \$2,793

- ▶ Pocket Park Maintenance \$2,793

2025 Service Plan

Transportation Services - \$178,937

- ▶ Road & Street Maintenance - \$97,291
- ▶ Sidewalk/Boulevard Maintenance- \$3,000
- ▶ Ditches/Road Drainage - \$1,525
- ▶ Street Cleaning - \$11,152
- ▶ Snow Removal - \$36,000
- ▶ Street Lighting - \$24,999
- ▶ Traffic Services - \$4,970

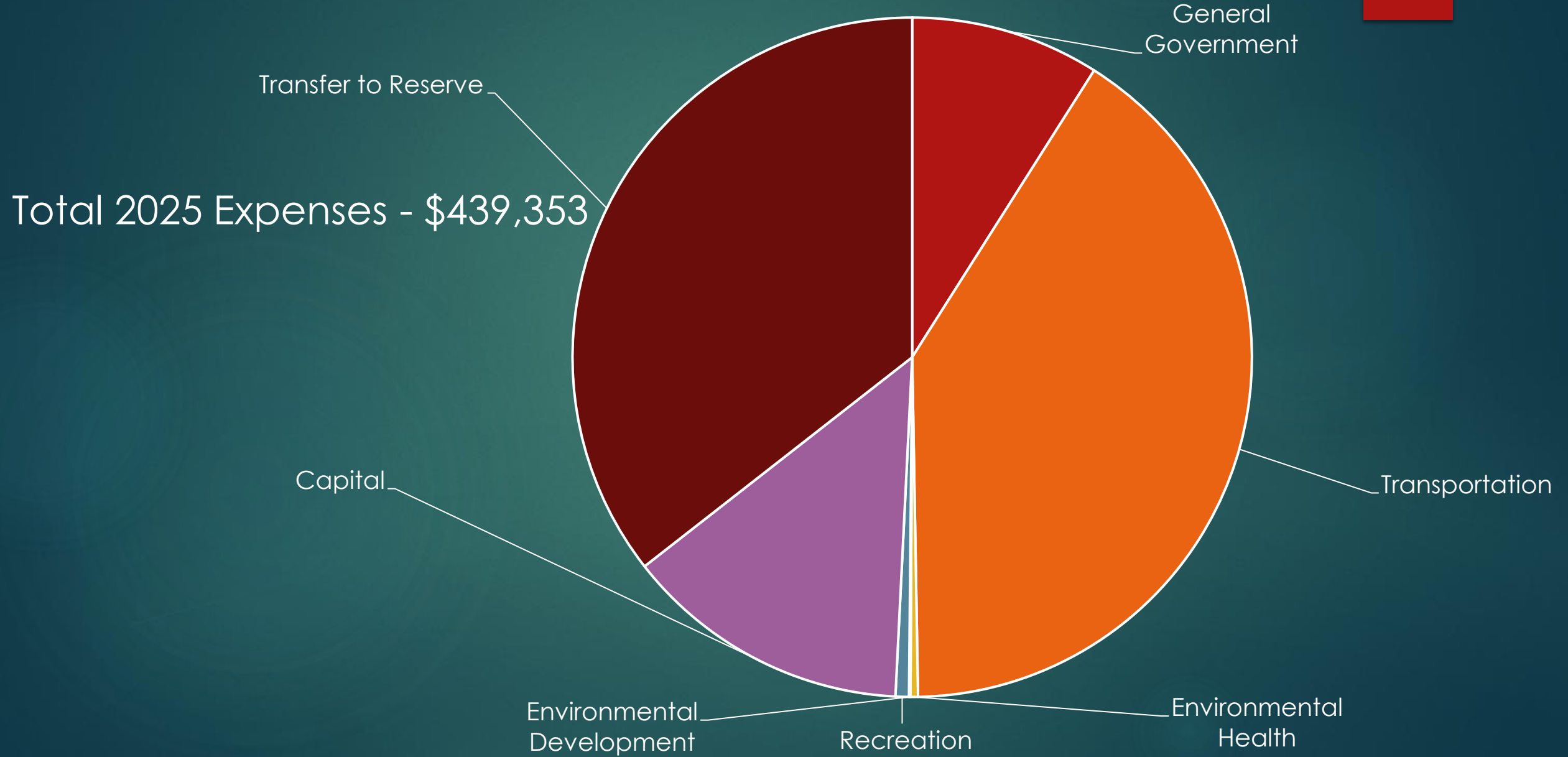

Transfer to Reserve

General Government

Total 2025 Expenses - \$439,353

Capital

Transportation

Environmental Development

Recreation

Environmental Health

2025 Reserve Balances

LUD Reserve:

2025 Beginning Balance on January 1	\$325,689
2025 Reserve withdrawal	-\$60,000
<u>2025 Reserve contribution</u>	<u>+156,215</u>
2025 Projected Ending Balance	\$421,904

LUD Sidewalk Reserve (from Developers' lot fees) \$18,144

LUD Greenspace Reserve (from Developers' lot fees) \$89,426

Year-end Reserve Balance 2015-2025

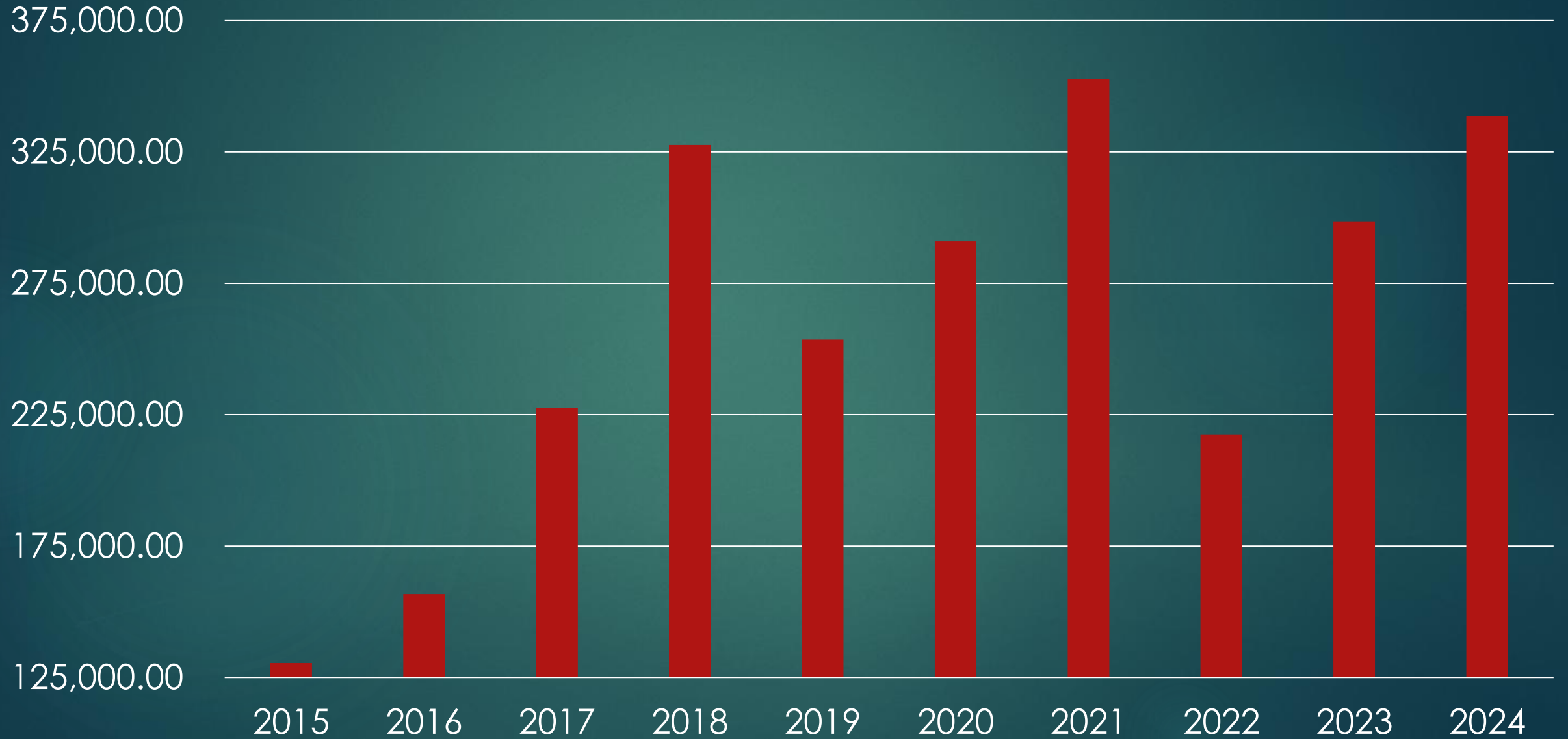

LUD of Grunthal

2025 Capital Plan

- ▶ Community Welcome Signs - \$60,000
- ▶ Sweeper \$11,000

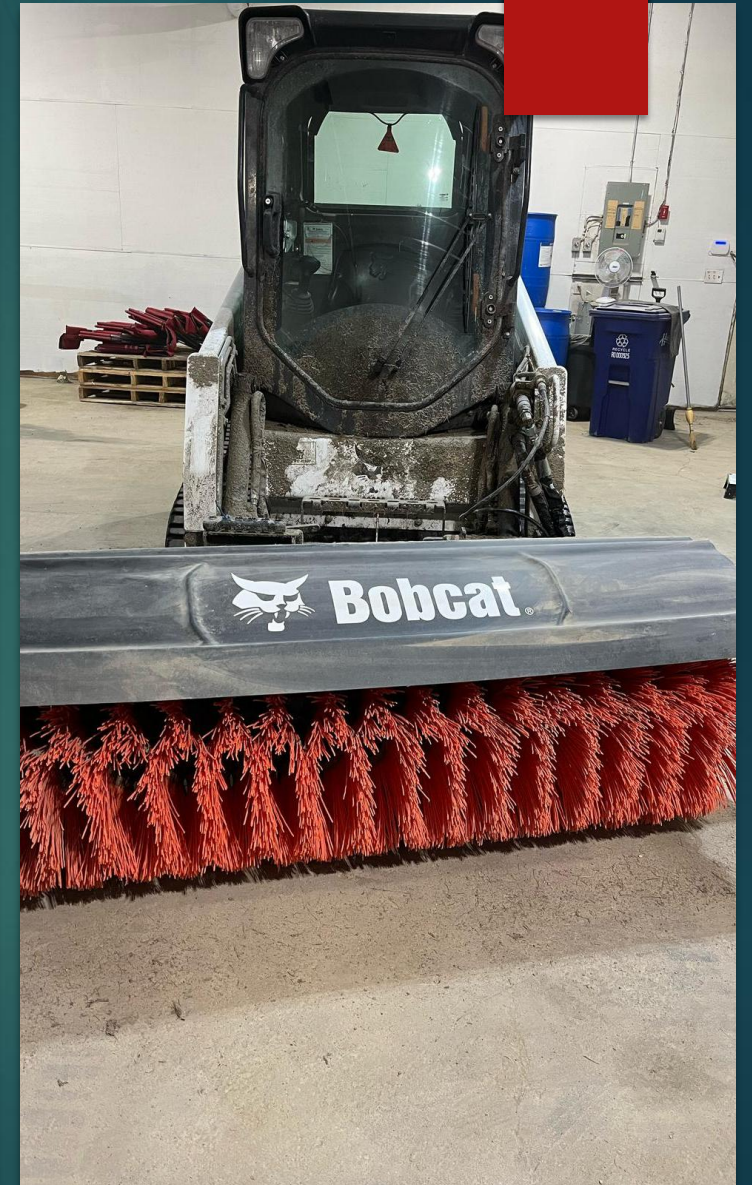



Chairperson's FYI:

Late in 2024, the GLUD started the Main Street to Pine Street drainage project which will be completed now in 2025.

The estimated cost of this project is \$76,000. This expense was not included in our 2024 plans.

2024 Completed Projects -

- ▶ New Christmas lights purchased along Main Street.
- ▶ Birch Street from Froese Road to Pine Street
- ▶ Geotechnical review of Spruce Street.
- ▶ A second speed sign for the community. It is currently along Main Street west.



Grants to organization:

The LUD has designated \$11,750 for grants in 2025

- Hanover Ag - \$5,000
- COPPs - \$5,000
- New Horizon's Seniors Centre - \$1,000
- DropZone (for hosting our Spring Community Clean-up) - \$500
- Family Fun Day - \$250

FUTURE CAPITAL PROJECTS:

We are doing less Capital Projects in 2025 to allow us to put more money into reserves to prepare for more street repairs in 2026 and 2027.

Capital Projects for 2026:

- Repave Southwood Street from Oak Avenue to Abbey Lane (Asphalt Overlay) -\$27,000
- Repair and repave Pine Street from Froese Road to Elm Avenue - \$89,250
- Repair and repave Elm Avenue from Pine Street to Main Street - \$46,960

Capital Plans for 2027:

- Repair and repave Ash Street from Elm Avenue to Oak Avenue - \$118,000
- Repair and repave Maple Avenue from Main Street to Wiens Road - \$138,800
- Purchase a new mower - \$30,000

Completed Project – Benches, flowerpots, garbage/recycling containers installed along our sidewalks throughout the community.





Active Transportation Network

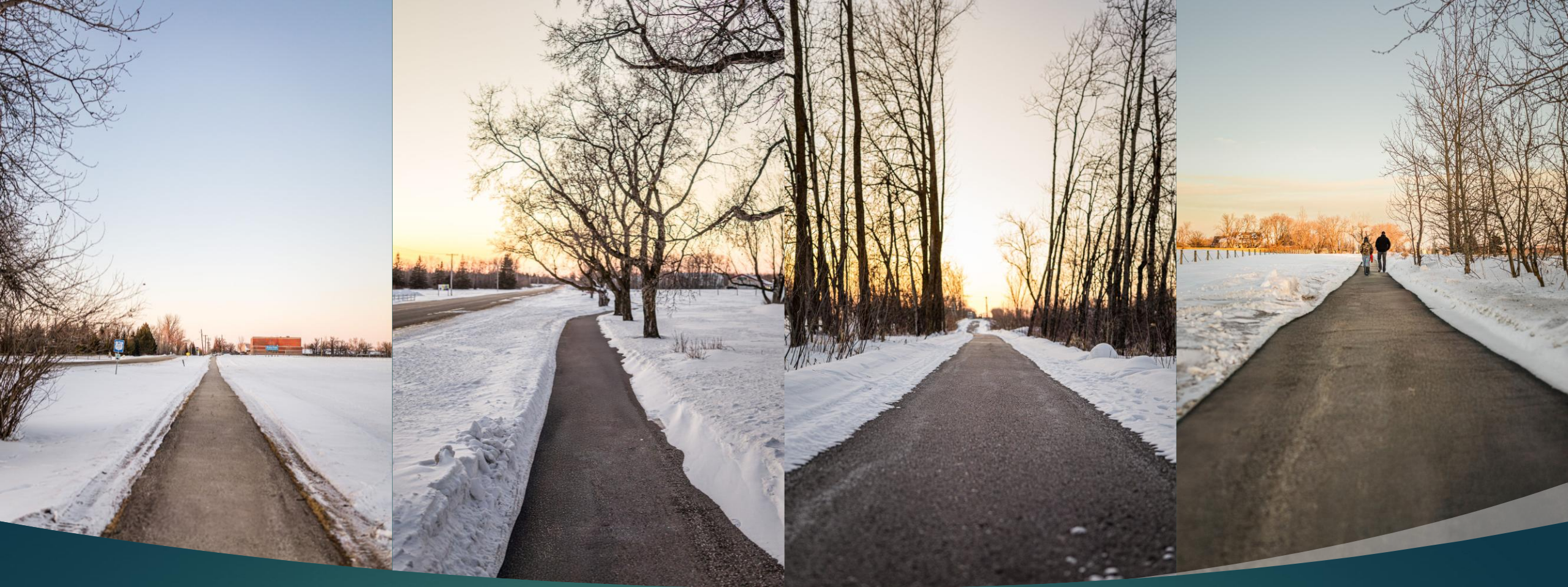

GLUD's Active Transportation pathways



GLUD's
new
Lead
Hand

Compost SPRING SCHEDULE 2025

MAY 2025

Sun	Mon	Tue	Wed	Thu	Fri	Sat
				1	2	3
4	5	6	7	8	9	10
11	12	13	14	15	16	17
18	19	20	21	22 GRUNTHAL CURBSIDE MITCHELL CURBSIDE	23 KLEEFFELD CURBSIDE BLUMENORT CURBSIDE	24
25	26 NEW BOTHWELL	27	28	29 GRUNTHAL CURBSIDE MITCHELL CURBSIDE	30 KLEEFFELD CURBSIDE BLUMENORT CURBSIDE	31

JUNE 2025

Sun	Mon	Tue	Wed	Thu	Fri	Sat
1	2 NEW BOTHWELL	3	4	5 GRUNTHAL CURBSIDE MITCHELL CURBSIDE	6 KLEEFFELD CURBSIDE BLUMENORT CURBSIDE	7
8	9 NEW BOTHWELL	10	11	12 GRUNTHAL CURBSIDE MITCHELL CURBSIDE	13 KLEEFFELD CURBSIDE BLUMENORT CURBSIDE	14
15	16 NEW BOTHWELL	17	18	19 GRUNTHAL CURBSIDE MITCHELL CURBSIDE	20 KLEEFFELD CURBSIDE BLUMENORT CURBSIDE	21
22	23 NEW BOTHWELL	24	25	26 GRUNTHAL CURBSIDE MITCHELL CURBSIDE	27 KLEEFFELD CURBSIDE BLUMENORT CURBSIDE	28
29	30 NEW BOTHWELL					

JULY 2025

Sun	Mon	Tue	Wed	Thu	Fri	Sat
		1	2	3 MITCHELL CURBSIDE	4 BLUMENORT CURBSIDE	5
6	7	8	9	10 MITCHELL CURBSIDE	11 BLUMENORT CURBSIDE	12

COMMUNITY DEPOT

New Bothwell
50 Park Bay
(Community Center)

OPERATIONAL HOURS
5:00PM TO 8:00PM
PLEASE **DO NOT** LEAVE BAGS
DURING NON-OPERATIONAL TIMES.

CURBSIDE COMPOST COLLECTION

L.U.D Mitchell THURSDAYS

L.U.D Grunthal THURSDAYS

L.U.D Blumenort FRIDAYS

NEW L.U.D Kleefeld FRIDAYS

CURBSIDE PICK UPS BETWEEN 7AM-7PM
NEED A GREEN BIN?
CALL 204-346-7129 EXT 0
EMAIL SOLIDWASTE@HANOVERMB.CA
L.U.D RESIDENTS ONLY

Compost FALL SCHEDULE 2025

AUGUST 2025

Sun	Mon	Tue	Wed	Thu	Fri	Sat
24	25	26	27	28 MITCHELL CURBSIDE	29 BLUMENORT CURBSIDE	30
31						

SEPTEMBER 2025

Sun	Mon	Tue	Wed	Thu	Fri	Sat
	1	2	3	4 MITCHELL CURBSIDE	5 BLUMENORT CURBSIDE	6
7	8 NEW BOTHWELL	9	10	11 GRUNTHAL CURBSIDE MITCHELL CURBSIDE	12 KLEEFFELD CURBSIDE BLUMENORT CURBSIDE	13
14	15 NEW BOTHWELL	16	17	18 GRUNTHAL CURBSIDE MITCHELL CURBSIDE	19 KLEEFFELD CURBSIDE BLUMENORT CURBSIDE	20
21	22 NEW BOTHWELL	23	24	25 GRUNTHAL CURBSIDE MITCHELL CURBSIDE	26 KLEEFFELD CURBSIDE BLUMENORT CURBSIDE	27 MITCHELL COMMUNITY DEPOT 130 ASH ST (ARENA) 9AM-3PM
28	29 NEW BOTHWELL	30				

OCTOBER 2025

Sun	Mon	Tue	Wed	Thu	Fri	Sat
			1	2 GRUNTHAL CURBSIDE MITCHELL CURBSIDE	3 KLEEFFELD CURBSIDE BLUMENORT CURBSIDE	4 MITCHELL COMMUNITY DEPOT 130 ASH ST (ARENA) 9AM-3PM
5	6 NEW BOTHWELL	7	8	9 GRUNTHAL CURBSIDE MITCHELL CURBSIDE	10 KLEEFFELD CURBSIDE BLUMENORT CURBSIDE	11 MITCHELL COMMUNITY DEPOT 130 ASH ST (ARENA) 9AM-3PM
12	13 NEW BOTHWELL	14	15	16 GRUNTHAL CURBSIDE MITCHELL CURBSIDE	17 KLEEFFELD CURBSIDE BLUMENORT CURBSIDE	18 MITCHELL COMMUNITY DEPOT 130 ASH ST (ARENA) 9AM-3PM
19	20 NEW BOTHWELL	21	22	23 GRUNTHAL CURBSIDE MITCHELL CURBSIDE	24 KLEEFFELD CURBSIDE BLUMENORT CURBSIDE	25 MITCHELL COMMUNITY DEPOT 130 ASH ST (ARENA) 9AM-3PM
26	27 NEW BOTHWELL	28	29	30 GRUNTHAL CURBSIDE MITCHELL CURBSIDE	31 KLEEFFELD CURBSIDE BLUMENORT CURBSIDE	

COMMUNITY DEPOT

New Bothwell
50 Park Bay
(Community Center)

OPERATIONAL HOURS
5:00PM TO 8:00PM
PLEASE **DO NOT** LEAVE BAGS
DURING NON-OPERATIONAL TIMES.

CURBSIDE COMPOST COLLECTION

L.U.D Mitchell THURSDAYS

L.U.D Grunthal THURSDAYS

L.U.D Blumenort FRIDAYS

NEW L.U.D Kleefeld FRIDAYS

CURBSIDE PICK UPS BETWEEN 7AM-7PM
NEED A GREEN BIN?
CALL 204-346-7129 EXT 0
EMAIL SOLIDWASTE@HANOVERMB.CA
L.U.D RESIDENTS ONLY

Garbage & Recycling 2025 SCHEDULE CHANGES



WHAT CAN BE Composted?

Pick Up Area	Service being Interrupted	Original Date	Date Change
Grunthal		Friday, April 18	Monday, April 21
Blumenort Kleefeld New Bothwell		Tuesday, July 1	Wednesday, July 2
Mitchell		Wednesday, July 2	Thursday, July 3
Grunthal		Friday, July 4	Monday, July 7
Blumenort Kleefeld New Bothwell		Tuesday, September 30	Wednesday, October 1
Mitchell		Wednesday, October 1	Thursday, October 2
Grunthal		Friday, October 3	Monday, October 6
Blumenort Kleefeld New Bothwell		Tuesday, October 14	Wednesday, October 15
Mitchell		Wednesday, October 15	Thursday, October 16
Grunthal		Friday, October 17	Monday, October 20
Blumenort Kleefeld New Bothwell		Tuesday, November 11	Wednesday, November 12
Mitchell		Wednesday, November 12	Thursday, November 13
Grunthal		Friday, November 14	Monday, November 17
Grunthal		Friday, December 26	Monday, December 29



Compostable

- ✓ Grass clippings
- ✓ Leaves
- ✓ Weeds (without seeds)
- ✓ Garden waste
- ✓ Peat moss
- ✓ Vegetables and fruits
- ✓ Coffee/filters, tea leaves/bags
- ✓ Egg shells
- ✓ Dead Flowers
- ✓ Compostable bags/Paper Bags



Not Compostable

- ✗ Branches, wood chips or sawdust
- ✗ Herbicide-treated grass clippings
- ✗ Meat and bones
- ✗ Dairy products
- ✗ Perennial and seed-bearing weeds
- ✗ Pet manure
- ✗ Diseased plants
- ✗ Metal
- ✗ Plastic/Plastic Bags

Community Compost Depot Info

DEPOTS ARE HELD ONCE PER WEEK BETWEEN 5:00 PM - 8:00 PM
DO NOT LEAVE BAGS OUTSIDE HOURS OF OPERATION ABOVE.

Curbside Compost Collection Info

ONLY COMPOST MATERIALS INSIDE THE BINS WILL BE COLLECTED.
 NO ADDITIONAL BAGS/MATERIALS BESIDE BINS.
 CONTENTS CAN ADDED TO THE BIN LOOSE OR IN COMPOST FRIENDLY BAGS.

BINS AT THE ROAD BY 7:00AM

NO PLASTIC BAGS!

Garbage & Recycling SCHEDULE

Pick Up Area	Day of the Week
BLUMENORT	TUESDAY
KLEEFELD	TUESDAY
ROSEVILLE DR, IVY RIDGE AREA	TUESDAY
MITCHELL AND AREA	WEDNESDAY
GRUNTHAL	FRIDAY
SHADY LANE, GREEN ACRES LANE AREA	FRIDAY

Schedule changes will be posted on our website, social media, and Community LED signs.



Grunthal's Community Christmas





SEINE RAT ROSEAU

WATERSHED DISTRICT

Rain Gardens

The SRRWD Rain Garden program provides funding and design support to property owners who wish to implement a rain garden to capture surface water runoff, rainwater, or sump pump discharge. A rain garden is a perennial garden planted in a shallow depression designed to capture and use water that may otherwise runoff. Rain gardens do NOT create standing pools of water but rather are a designated place for water to infiltrate into the ground (generally within 24 – 48 hrs of a rain event). The SRRWD will provide up to \$5,000.00 (50% cost-share) for schools and public spaces to establish a rain garden. We also provide grants of \$750.00 to homeowners who establish a rain garden on their property.





LUD OF GRUNTHAL
**BY-ELECTION
DAY**

**Wednesday,
May 21st, 2025**

8:00 am - 8:00 pm

**Grunthal Arena Lobby
63 Albert Avenue**



For more information regarding the municipal election visit
www.hanovermb.ca/

Grunthal's Citizen on Patrol Program



Establishing Citizens On Patrol Program In Your Community

Community members play a crucial role in COPP. The program would not exist without their support and dedication.

Any individuals or groups who identify a safety concern in their community can consider establishing a local COPP group and can apply to join the provincial program.

Manitoba COPP will provide groups with support and resources, including the necessary equipment and training to establish their COPP group.

How To Start And Run A COPP Group (Overview)

- Contact the Manitoba COPP or your local law enforcement office for direction and support. A Regional Representative may be available to come and talk to anyone interested in COPP.
- After a community meeting and/or reading all the information, if the group decides to organize the program, they will need to receive approval from their local law enforcement agency to start the group

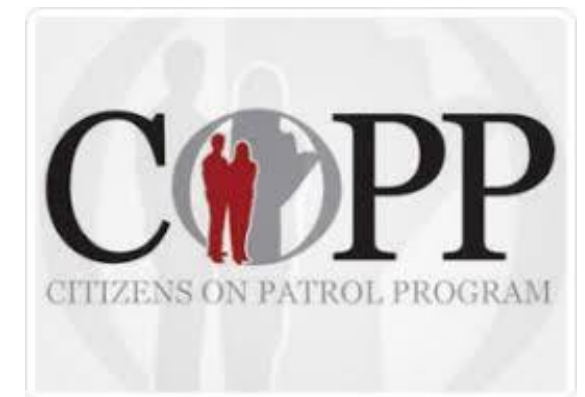

Grunthal Arena Modernization Project



New Horizon's Seniors Centre Update

Vision Statement:

To enhance the well-being of our community seniors by providing them with purpose, encouragement, friendship, laughter and connection.

Here's an update of what's been happening at New Horizon's within the last year:

- Weekly Coffee Times (October – April)
- Monthly Suppers and music
- Hymn Sings
- BINGO
- Canvas Painting Classes





Planning Department

DEVELOPMENT PLAN & ZONING BY-LAW REVIEW

- Why review the Development Plan & Zoning By-Law?
 - Under the authority of The Planning Act, The Province of Manitoba requires municipalities to review their Development Plans on a regular basis, usually every 5 years.
 - Due to Hanover's consistent growth, a regular review is important to ensure the Municipality is growing and developing in a sustainable manner.
- When was the last review?
 - The Municipality commenced the last development plan review in 2016.
 - Current Development Plan & Zoning By-Law were adopted on March 13, 2019
- Who is conducting the review?
 - The Municipality has contracted Landmark Planning & Design Inc to spearhead this initiative.
- What is the cost?
 - The project is estimated to cost up to \$90,000. The Municipality has applied for a grant under the "From the Ground Up – Safe Healthy Communities For All" program with hopes of receiving up to 50% funding

- How long will this project take?
 - The total project is anticipated to take between 18-24 months. See the below outline.

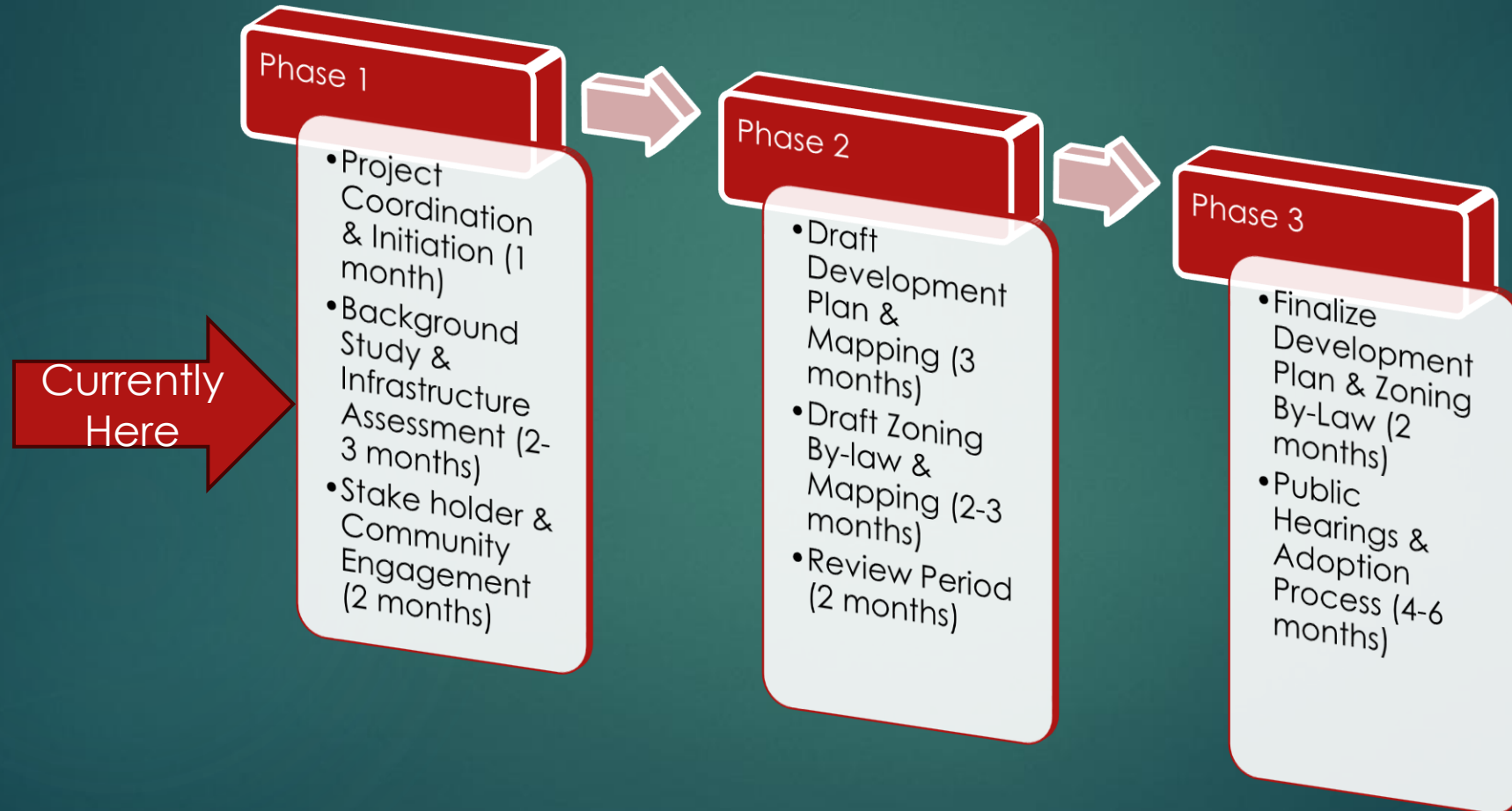

Note: some tasks may occur concurrently with others

Proposed Developments in Grunthal



Growth of Wastewater Capacity in Manitoba

An Introduction to RSR Wastewater Cooperative



Who is RSR?

- RSR is the Red-Seine-Rat Wastewater Cooperative, a group of 6 municipalities in southeastern MB that have banded together to provide a regional solution to the restrictions to growth that current wastewater facilities have caused.
- RSR was originally formed in 2019 between 4 municipalities: the RM's of Hanover, Ritchot, and Tache, as well as the Town of Niverville.
- In 2024, RSR was further joined by two other members: the RM of La Broquerie and the communities of Otterburne & Providence University College inside the RM of De Salaberry.
- RSR will, once completed, provide wastewater treatment to service 12,600 new housing units, or a rough population total of 101,000.
- Over 90km of new pipeline will be build to connect current wastewater treatment in the associated communities to the new treatment facility.



Who is RSR?

- RSR is the Red-Seine-Rat Wastewater Cooperative, a group of 6 municipalities in southeastern MB that have banded together to provide a regional solution to the restrictions to growth that current wastewater facilities have caused.
- RSR was originally formed in 2019 between 4 municipalities: the RM's of Hanover, Ritchot, and Tache, as well as the Town of Niverville.
- In 2024, RSR was further joined by two other members: the RM of La Broquerie and the communities of Otterburne & Providence University College inside the RM of De Salaberry.
- RSR will, once completed, provide wastewater treatment to service 12,600 new housing units, or a rough population total of 101,000.
- Over 90km of new pipeline will be build to connect current wastewater treatment in the associated communities to the new treatment facility.



Community organizations

- ▶ Drop Zone
- ▶ Grunthal Lions Club
- ▶ Hanover Ag



Hanover Ag



SPRING TWIST OFF

JUNE 6, 2025 | 7 PM
Tickets: \$30 (5 & under free)



HEARTLAND RODEO

Finals & Banquet



SEPTEMBER 13-14

RYAN LANGDON AT THE FAIR

FEATURING
THE SEAN
TAYLOR BAND



SATURDAY, AUGUST 16



FAIRWAY FORD MAINSTAGE
GATES OPEN: 6 PM | SHOW: 7 PM
TICKETS: \$30 (5 & UNDER FREE)

WWW.HANOVERAG.COM

HANOVER AG'S BULL RIDERS CANADA INVITATIONAL

PRESENTED BY STEINBACH FEEDS



THURSDAY, AUGUST 14 FRIDAY, AUGUST 15

KEYSTONE AGRI-MOTIVE LIVESTOCK ARENA
GATES OPEN: 6 PM | SHOW: 7 PM
TICKETS: \$30 (5 & UNDER FREE)

WWW.HANOVERAG.COM



MANITOBA MUD MAFIA MUD RACES AT THE FAIR

PRESENTED BY
SOUTHWOOD
VENTURES INC.



SATURDAY, AUGUST 16 | 4 PM - 7PM



SOUTHWOOD VENTURES SPEEDWAY
HANOVER AG EXHIBITION PARK
ADMISSION: INCLUDED WITH FAIR GATE FEE

WWW.HANOVERAG.COM



**SEE YOU
AT THE FAIR**



HANOVER AG EXHIBITION PARK
GRUNTHAL, MB
WWW.HANOVERAG.COM



DRIVE THRU CHRISTMAS LIGHT SHOW

SNOW PLACE

Like Home



HanoverAg EXHIBITION PARK

Coming Back

CHRISTMAS 2025





HANOVER AG

EVENT VENUE

HANOVER AG

EVENT VENUE



*Commercial
Kitchen
&
Meeting Space*



WWW.HANOVERAGEVENTVENUE.COM

HANOVER AG

EVENT VENUE



Rental Amenities

EXPANSIVE TENT
MULTIPLE CEREMONY SITES
INDOOR MEETING ROOM
COMMERCIAL KITCHEN
OUTDOOR STAGE
LIVESTOCK ARENA



WWW.HANOVERAGEVENTVENUE.COM

ENHANCING RECREATION IN HANOVER

**A New Recreation Delivery
System and Evolving
Committee Roles**



INTRODUCTION & PURPOSE

01

WHY CHANGE
WAS NEEDED.

02

OVERVIEW OF
NEW RECREATION
DELIVERY SYSTEM.

03

HOW THIS
BENEFITS THE
COMMUNITY AND
VOLUNTEERS.

WHAT'S CHANGING

Operations/Maintenance shifted to RM of Hanover.

- **Grass Cutting, Parks and Playground Maintenance, Splash Pad, Sport Fields, Outdoor Rink and Skating Trails.**
- **Unified Parks/Capital Budgets and Operations.**

Community Rec Committee will oversee:

- **Programming, Community Events, assist in future visioning and planning.**
- **Community: Small Committees, more defined roles.**



RECREATION COMMITTEE STRUCTURE AND RESPONSIBILITIES

3 Community Members + 1 LUD Member + Councilor

- ***Committees currently larger than 3 members can continue to operate as they are currently. When terms expire, and members are departing, new committee size will be established.

Nomination process to fill openings.

- Council will appoint committees based on nominations.

Meeting Frequency: 4-6 times per year

Key Focus Areas:

- **Community Programming**
- **Special Events**
- **Visioning and Planning** for future needs.



RECREATION AND COMMUNITY SERVICES DEPARTMENT (HANOVER)

- Operations and Maintenance
 - Staffing.
 - Maintenance of Parks, Greenspaces, Playgrounds, Splashpads, Sport Fields/Diamonds, Outdoor Skating including ODR's and Skating trails, toboggan slide etc.
 - Patron Feedback available through barcode scan.
 - Facility Rentals, invoicing, program registrations, payments.
- 

- Less Burden on Volunteers.
- More community-driven programming.
- Efficient and focused meetings.
- Flexible Schedules (including virtual options possible based on need).
- Enhanced ability for Hanover to consider larger capital projects by pooling resources.
- More efficient use of resources, including staff and equipment between communities.

BENEFITS OF NEW MODEL



NEXT STEPS AND IMPLEMENTATION TIMELINE

1

Community nominations
for open committee spots
– Spring 2025.

- Council Selection of new committee members (where required).

2

Training and Onboarding
for new committee
members – June 2025.

3

Transition period for new
roles and responsibilities



**2024
CAPITAL
PROJECTS
RECAP**

**Kiddie Park (Pine/Elm
Street)**

**Trail Connection – Hanover
Ag through Soccer Park**



KIDDIE PARK (PINE/ELM STREET)

- New in 2025





GRUNTHAL ARENA MODERNIZATION PROJECT



FUTURE CAPITAL PROJECTS

Grunthal Arena Modernization Project

- **RM of Hanover Council supports project.**
 - **Budgeted at 4.5 Million Dollars**
 - **Local Fundraising Goal- \$2 Million (Currently \$1.2 Million committed)**
 - **RM funding -\$2.5 Million**
 - **Application made to Federal Grant Program for assistance.**
 - **Concept design done**
 - **Currently working with professional firm to continue design process and refine the project**

Goal would be for construction in 2026 or 2027.

GRUNTHAL REC COMMITTEE

Volunteers

- Michelle Penner
- Megan Harder
- Connie Gauthier
- Rebecca Hiebert

Council

- Curtis Dawydiuk

LUD

- Thomas Guenther

Family Fun Day – Sept 6, 2025

Centennial Park

- Various Family Activities
- Public Swimming
- Pancake Breakfast
- Entertainment

EVENTS & PROGRAMMING



EVENTS & PROGRAMMING CONT'D

- Christmas Tree Lighting
 - Food Trucks
 - Sleigh Rides
 - Public Skating
 - Santa Visit
 - Caroling
 - Bonfires

EVENTS & PROGRAMMING CONT'D

Swimming

Baseball

Soccer

Pickleball

Slo-Pitch

Hockey

Rec Hockey

Can Skate

Toddler Shenanigans

Basketball

Thank you to all our sponsors & volunteers!!

- 13.5 KM of Active Transportation Trails

ACTIVE TRANSPORTATION NETWORK
EXISTING
FUTURE/PLANNED



eNEWS



HAVE YOU HEARD?

STAY UP TO DATE ON HANOVER ENEWS BY SUBSCRIBING TO OUR MONTHLY NEWSLETTER!

ALL **CURRENTLY REGISTERED SUBSCRIBERS ALONG WITH THE NEW ONES** WILL HAVE A CHANCE TO WIN ONE OF THREE HANOVER-OWNED RECREATIONAL CENTRE HALL RENTALS AT THE LOCATION OF THEIR CHOICE. DRAWS WILL TAKE PLACE IN MAY 2025.

SUBSCRIBE ON OUR WEBSITE TODAY!

WWW.HANOVERMB.CA/P/SUBSCRIBE

FREE DRAW SIGN UP NOW





eNEWS

FREE DRAW SIGN UP NOW

WWW.HANOVERMB.CA



STAY IN THE LOOP

Want to stay up to date with what's happening in your community?

Follow us on our social media pages!



RuralMunicipalityofHanover
RMofHanoverRecreation



@rmofhanover
@rmofhanoverrecreation



eNEWS

April 2025



CONTACT INFO

28 Westland Dr, Mitchell MB R5G 2N9

204.326.4488

general@hanovermb.ca

www.hanovermb.ca

STAY IN THE LOOP

Want to stay up to date with what's happening in your community? Follow us on our social media pages!



RuralMunicipalityofHanover
RMofHanoverRecreation



@rmofhanover
@rmofhanoverrecreation

GREAT PLACE TO LIVE, WORK & PLAY

CONNECTIONS

Reeve

Jim Funk 204.371.2737, jim.funk@hanovermb.ca



Councillors

Travis Doerksen (Ward 1) 204.371.1949, travis.doerksen@hanovermb.ca

Brian Esau (Ward 2) 204.326.8504, brian.esau@hanovermb.ca

Roberto Hiebert (Ward 3) 204.392.8544, roberto.hiebert@hanovermb.ca

Ed Penner (Ward 4) 204.326.8515, ed.penner@hanovermb.ca

Darrin Warkentin (Ward 5) 204.346.3077, darrin.warkentin@hanovermb.ca

Curtis Dawydiuk (Ward 6) 204.371.2950, curtis.dawydiuk@hanovermb.ca

CAO

Luc Lahaie 204.371.9881, luc.lahaie@hanovermb.ca

UPCOMING COUNCIL MEETINGS

Apr. 9, 2025 - 9:00 a.m.

Apr. 23, 2025 - 4:00 p.m.

May 14, 2025 - 9:00 a.m.

May 21, 2025 - 4:00 p.m.





LUD OF GRUNTHAL
BY-ELECTION DAY

**Wednesday,
May 21st, 2025**

8:00 am - 8:00 pm

**Grunthal Arena Lobby
63 Albert Avenue**

For more information regarding
the municipal election visit
www.hanovermb.ca/



Dawn Oude Voshaar 204.377.4830
Randy Peters 204.371.9696
Travis Fehr 204.371.1357

Kleefeld
**Community Service Plan
MEETING**

APRIL 8, 2025

7:00 P.M.

KLEEFELD

RECREATION CENTRE



**THIS IS YOUR OPPORTUNITY TO GET INVOLVED,
STAY INFORMED, AND SHARE YOUR IDEAS FOR
MAKING YOUR COMMUNITY EVEN BETTER!**



PROTECTIVE SERVICES

Community Safety Officer
204.346.7131
cso@hanovermb.ca



SPRING ROAD RESTRICTIONS ARE IN EFFECT

AS OF 6:00 A.M. TUESDAY, MARCH 25, 2025

CONTINUING UNTIL

11:59 P.M. ON THURSDAY, MAY 29, 2025*

The Rural Municipality of Hanover has posted certain roads at 65% of the normal axle loading's on B1 Municipal roads.

Roads that are restricted are appropriately signed and restrictions will continue until signs are removed.

Map with affected roads can be found on our website.

<https://maps.hanovermb.ca/Viewer/index.html?viewer=RoadRestrictions>



Questions
or Concerns,
contact the
Community
Safety Officer

(info above)

The fines for non-compliance will be based on the weight over the allowable limit. The bylaw states, **\$25 fine for every 50kg** that a load is overweight.

COMMUNITY ENEWS



BLUMENORT

Kevin Medeiros 204.371.6309
Roger Dueck 204.392.4564
Floyd Penner 204.392.2713

On March 31, the Local Urban District (LUD) of Blumenort hosted our annual general meeting, where we had the opportunity to share our 2025 service plan and gather valuable feedback from residents. Some of the upcoming projects that we are excited to announce include:

- New sidewalk installation along Crestview and Edgemont to improve pedestrian safety and accessibility.
- Re-surfacing of Parkview Bay to enhance road conditions and ensure smoother travel.
- A brand-new dog park in the green space off Harvest Bay, providing a dedicated area for our four-legged friends to play and socialize.
- A new walking path around the retention pond on Stoney Creek Drive.
- Various asphalt repairs throughout town to maintain and improve road quality.

*Thank you for making our
Community Service Plan
meeting a success.
We look forward to another
productive year of community
improvements.*



CHIEF ADMINISTRATIVE OFFICER

Contact Information:

luc.lahaie@hanovermb.ca or 204.371.9881

FINANCE & ADMINISTRATION

Contact Information:

general@hanovermb.ca or 204.326.4488; finance@hanovermb.ca

NEW BOTHWELL



LOTS ARE FULLY SERVICED WITH:

- 3 PHASE ELECTRICITY
- NATURAL GAS
- LOW PRESSURE SEWER
- CO-OP WELL
- ASPHALT SERVICE ROAD
- CURBS & GUTTERS
- STREET LIGHTS

NOW SELLING
LIGHT INDUSTRIAL LOTS
STARTING AT
\$145,900.00

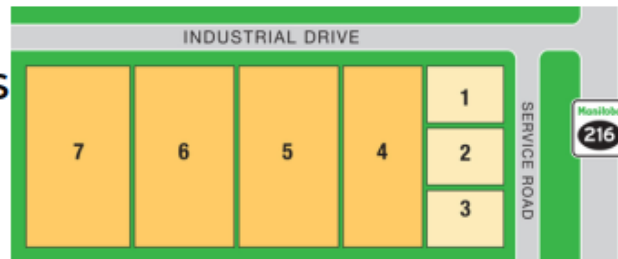

MICHELLE HARTIN
REALTOR®
204-746-5850
HELPFULHARTIN@GMAIL.COM

2025 Financial Plan hearing is scheduled for
Wednesday, April 23, 2025 at 4:45 in the
Council chambers at our main office at
28 Westland Drive.

The hearing is open to the public and residents
are encouraged to attend if they have questions
about planned services and projects for 2025.



ACCEPTED PAYMENT METHODS

CASH **CHEQUE** **DEBIT CHECK DAILY LIMIT!**
CREDIT CARD FEES APPLY **IN-PERSON OR ONLINE**
ONLINE BANKING **DROP BOX**



Upcoming
Office
Closures:

April 18, 2025
 May 19, 2025
 July 1, 2025
 August 4, 2025
 September 1, 2025
 September 30, 2025
 October 13, 2025
 November 11, 2025

PLANNING & PERMITS

Contact Information:

planning@hanovermb.ca or 204.346.7126; permits@hanovermb.ca or 204.346.7125

Hanover is on track to outperform 2025 in residential construction. The total value of permits issued to date is \$8.2 million; with a year over year increase of 39% in the number of new units permitted or under construction. Year to date, Hanover's total permits value is up 18% from approx. \$9.5 million in 2024 to \$11.2 million in 2025.

Please visit www.hanovermb.ca for more information.



Building permit holders should keep in mind that road restrictions are now in effect until May 29, 2025 unless otherwise posted on website: www.hanovermb.ca.

WORKS & OPERATIONS

Contact Information:

worksandoperations@hanovermb.ca or 204.346.7129



BOULEVARD & STREET SWEEPING

SCHEDULES WILL BE POSTED SOON!

CHECK OUR WEBSITE, SOCIAL MEDIA, & LED SIGNS FOR DATES

COMING SOON
TO KLEEFELD

curbside composting

The LUD of Kleefeld is making a change to compost collection by rolling out automated Curbside Compost bins! These bins will replace the community compost depot and offer the optional, weekly service to residential properties, right at your curb instead!

Curbside Compost will be collected in Spring every **Friday** starting **May 23rd** up to and including **June 27th** just like garbage and recycling is collected. Compost collection will resume again in Fall.



A flyer with more details will be included in your quarterly utility bill.

PROTECTIVE SERVICES



Fire Chief
204.346.7130
paul.wiebe@hanovermb.ca



GRUNTHAL FIRE DEPARTMENT ANNUAL SPRING SUPPER & SILENT AUCTION

SATURDAY APRIL 12, 2025 | 5:30 PM
GRUNTHAL FIRE DEPARTMENT

(FUNDS WILL ALSO BE USED TO SUPPORT OUR SCHOLARSHIP FOR HIGH SCHOOL STUDENTS THAT WISH TO ATTEND FIRE COLLEGE)

REMINDER

**Burning of leaves and sticks
is prohibited in towns and rural
residential areas!!**

BY-LAW NO. 2523-22

PROTECTIVE SERVICES



Fire Chief
204.346.7130
paul.wiebe@hanovermb.ca

Emergency Operations Centre (EOC) Volunteer Opportunities



RM of Hanover has a volunteer based Emergency Operations Centre (EOC) Team that is led by the Emergency Operations Coordinator, Paul Wiebe, RM of Hanover Fire Chief.

In the event of an emergency, the Emergency Operations Centre will be activated to support residents in accordance with the RM of Hanover's Emergency Plan. The Emergency Operations Centre Team convenes about four times annually to assess the emergency plan and prepare for potential crises.

If you are interested in becoming part of this team, please contact Paul Wiebe by e-mail paul.wiebe@hanovermb.ca for available positions.

ENGINEERING & UTILITIES

Contact Information:

utilities@hanovermb.ca or 204.346.7129

Cleaning water softeners and hot water tanks is essential to address yellowing water that may have built up in a home's plumbing system. Over time, mineral deposits, such as iron and calcium, can accumulate in these systems, leading to discolored water. Here's how to clean both systems effectively:

Cleaning the Water Softener:

Regenerate the system: Run a manual regeneration cycle on the water softener to flush out built-up minerals.

Clean the resin tank: For more stubborn buildup, use a cleaning solution specifically designed for water softeners, or a mixture of bleach and water (consult the manufacturer's instructions). This helps remove iron and other contaminants.

Rinse thoroughly: After using the cleaning solution, ensure that the resin tank is thoroughly rinsed to prevent any chemicals from affecting the water quality.

Cleaning the Hot Water Tank:

Turn off the power and water supply: To safely clean your hot water tank, first shut off the power (for electric heaters) or gas supply (for gas heaters), and turn off the water supply.

Drain the tank: Attach a hose to the drain valve and let the tank fully drain. This helps flush out any sediment and minerals that may be causing discoloration.

Clean the tank: For deeper cleaning, use a long brush to scrub the interior, particularly if there's visible buildup. You can also add a descaling agent or vinegar to help remove mineral deposits.

Flush and refill: Once the tank is cleaned, close the drain valve, open the water supply, and allow the tank to refill. Check for leaks or any remaining sediment.

By regularly cleaning these systems, you can significantly reduce yellowing water caused by mineral buildup, improving both water quality and the efficiency of your plumbing.

ENGINEERING & UTILITIES

Contact Information:

utilities@hanovermb.ca or 204.346.7129



Monthly Water Main Flushing

Water main flushing in Kleefeld and Grunthal will resume in May.

Kleefeld: 2nd Wed/Thurs

Grunthal: 3rd Wed/Thurs

QUARTERLY UTILITY BILLS for Grunthal/Kleefeld



Quarterly utility bills for Kleefeld and Grunthal will be sent out after April 1 with a due date of April 30, 2025.

ANNUAL SEWER USER BILLS for Blumenort, Mitchell & New Bothwell

Annual sewer user bills will be sent out in April/May and will be due the same time as property taxes,

October 17, 2025.





GRUNTHAL

Anita Funk 204.371.9134
Thomas Guenther 204.392.9216
Paul Perreault 204.371.6665

Grunthal Community Service Plan MEETING



**APRIL 7, 2025
7:00 P.M.**

NEW HORIZON SENIOR CENTRE



**Grunthal Community Clean Up Friday, May 2nd
Meet at the Grunthal DropZone at 6 p.m.
Dress for the weather.
Barbecue to follow.**



HELP KEEP YOUR COMMUNITY CLEAN!



GRUNTHAL



Calling all Candidates...

**The registration period for the
2025 LUD of Grunthal by-election
is open!**

**RM of Hanover is accepting candidate
registration for the position of LUD of Grunthal Member.**

**Nomination Deadline:
April 15, 2025 @ 4pm**

For more information
on running for LUD of Grunthal Committee visit
www.hanovermb.ca/p/2025-lud-of-grunthal-by-election
All inquiries: SEO@hanovermb.ca or
Call Senior Elections Officer: Lois Gresiuik 204.392.2173

RECREATION ENEWS



Upcoming Programs:

This year's Blumenort Summer Camp theme is "I Rock! Digging into Adventure"! Campers will enjoy exciting activities, including splashing around at the Blumenort Splash Pad, with a special one-time morning tour of a Fast Brothers gravel pit!



Upcoming Programs:

Swimming Lesson Registration is OPEN! Register online today at the RM of Hanover Website: Parks & Recreation > Register for a Program

Upcoming Events:

Mark your calendar for **April 26!** Starting at 5:00 PM, join us for the Arena Renewal Fundraiser! Enjoy great food and top-notch entertainment. Tickets can be bought at **Grunthal Lumber, Grunthal Grocery,** and the **RM of Hanover Office!** You won't want to miss it!



Upcoming Programs:

Kleefeld Soccer
Registration opens: March 4 at 8:00 a.m.

Deadline: **April 3 at 11:55 p.m.**

PreK-Gr. 6: Tuesdays & Thursdays 7:00-8:00 p.m.

PreK-K and Gr. 1-2 are full, but the waitlist is open!



RECREATION ENEWS



Upcoming Programs:

Mitchell Soccer
Registration opens: March 4 at 8:00 a.m.
Deadline: **April 3 at 11:55 p.m.**
PreK-K: Tuesdays 5:30-6:15 p.m.
Grades 1-4: Tuesdays, 6:30-7:30 p.m.
PreK-K is full, but the waitlist is open!



Upcoming Programs:

Don't forget to sign up for Toddler Shenanigans!
Happening every other Saturday from 10:00-11:00 a.m.
Have you heard? New Bothwell Soccer is back!
Registration opens: March 4 at 8:00 a.m.
Deadline: **April 3 at 11:55 p.m.**
Ages 5-12 | Mondays, 6:30-7:30 p.m.



Share Your Input!

The RM of Hanover is committed to providing programs and activities that reflect the needs and interests of our community. We invite you to take part in our Recreation Programming Survey to help us plan for the future.



<https://forms.gle/FpCW8MAR7gicJDtF6>



MITCHELL

Brad Kehler 204.326.9583
Tim Fehr 204.392.6127
Cliff Froese 204.905.4056

Mitchell Community Service Plan MEETING



APRIL 1, 2025
7:00 P.M.
MITCHELL
RECREATION CENTRE



MITCHELL COMMUNITY SPRING CLEAN UP

SATURDAY, MAY 3
9:00 A.M. - 12:00 NOON
LUNCH FOR ALL VOLUNTEERS!
HELP KEEP YOUR
COMMUNITY CLEAN!



NEW
BOTHWELL

Ernest Kehler 204.392.0645
Irma Friesen 204.388.6293
Rob Hiebert 204.371.1216

New Bothwell Community Service Plan MEETING

APRIL 3, 2025
7:00 P.M.
NEW BOTHWELL
RECREATION CENTRE



THIS IS YOUR OPPORTUNITY TO GET INVOLVED,
STAY INFORMED, AND SHARE YOUR IDEAS FOR
MAKING YOUR COMMUNITY EVEN BETTER!

GRUNTHAL ARENA

SATURDAY 26TH APRIL, 2025

ARENA RENEWAL FUNDRAISER



FOOD TRUCKS 5 PM

**DUKES
DEXTERS
AND MORE**

ENTERTAINMENT 6 PM

**MATT FALK
THE DUMPSTER FIRES
THE GOOD 'OL BOYS**



\$25/PERSON (12 & UNDER ARE FREE)
TICKETS AVAILABLE IN ADVANCE AT THE FOLLOWING LOCATIONS:
GRUNTHAL LUMBER, GRUNTHAL GROCERY & RM OF HANOVER OFFICE

FLAG FOOTBALL IS COMING TO OUR COMMUNITY!



\$117

per athlete

- ✗ No experience required
- ✗ Open to ages 9-13
- ✗ U10, U12 & U14
- ✗ Boys and Girls

Includes one Blue Bombers ticket to pre-season home game in 2025.

**TO REGISTER & LEARN MORE, VISIT:
BLUEBOMBERS.COM/HANOVERFLAGFOOTBALL**

W FLAG FOOTBALL

NIVERVILLE • RITCHOT • HANOVER

