

L.U.D. of  
Kleefeld

2025  
Service Plan &  
Community  
Projects



# Introductions

## Kleefeld Local Urban District Committee:

- Dawn Oude Voshaar – Chair (204) 377-4830
- Travis Fehr (204) 371-1357
- Randy Peters (204) 371-9696
- Darrin Warkentin Ward 5 Councillor

**Luc Lahaie, CAO**  
**RM of Hanover**

# Agenda

- 2025 Service Plan
- 2025 Capital and Construction Projects
- 2024 Completed Projects
- Community Recreation Board Presentations
- Community Services and Offerings

# What's an LUD?

The RM is the local authority responsible for overall operation of the municipality

The LUD has been delegated certain duties:

- Road Maintenance (repairs, snow removal, street cleaning)
  - Drainage/Ditch Maintenance
  - Street Signage and Street Lighting
  - Sidewalk and Boulevard Maintenance (including mowing)
  - Composting and Solid Waste services (not provided by the RM program)
  - Weed Control
  - Public Parks Management (when not overseen by recreation department)
- 
- LUD sets service levels and annual mill rate for the community
  - LUD is not responsible for planning issues (zoning, CUs, variations and subdivisions)
  - Council and Administration works closely with the LUD Committee on all areas that impact residents

# 2025 Service Plan

- The LUD will be levying \$467,537 this year.
- Mill rate will decrease by 0.834 mills, from 5 to 4.166 mills
- Kleefeld's overall total municipal taxes (At-large and LUD rates) will be increasing slightly by \$74 for the average home.

# Tax Comparison - \$350,000 Residential Property

Assessment adjusted for 20.2% average increase in assessment, \$420,700

Excludes solid waste fees and utility fees

| Area         | 2024  | 2025  | Change | % of Change |
|--------------|-------|-------|--------|-------------|
| Mitchell     | 1,612 | 1,583 | (29)   | (1.80%)     |
| Grunthal     | 1,981 | 2,137 | 156    | 7.87%       |
| Blumenort    | 1,116 | 1,278 | 162    | 14.51%      |
| New Bothwell | 1,727 | 1,841 | 114    | 6.60%       |
| Kleefeld     | 1,613 | 1,687 | 74     | 4.59%       |
| Rural        | 1,570 | 1,698 | 128    | 8.15%       |

# 2025 Service Plan

|  |          |
|--|----------|
| General Government – (Indemnities, meetings)                 | \$26,283 |
| Environmental Health – (Supplemental Composting)             | \$100    |
| Environmental Development Services – (Weed Control)          | \$600    |
| Recreation and Cultural Services – (Pocket Park Maintenance) | \$400    |

# 2025 Service Plan

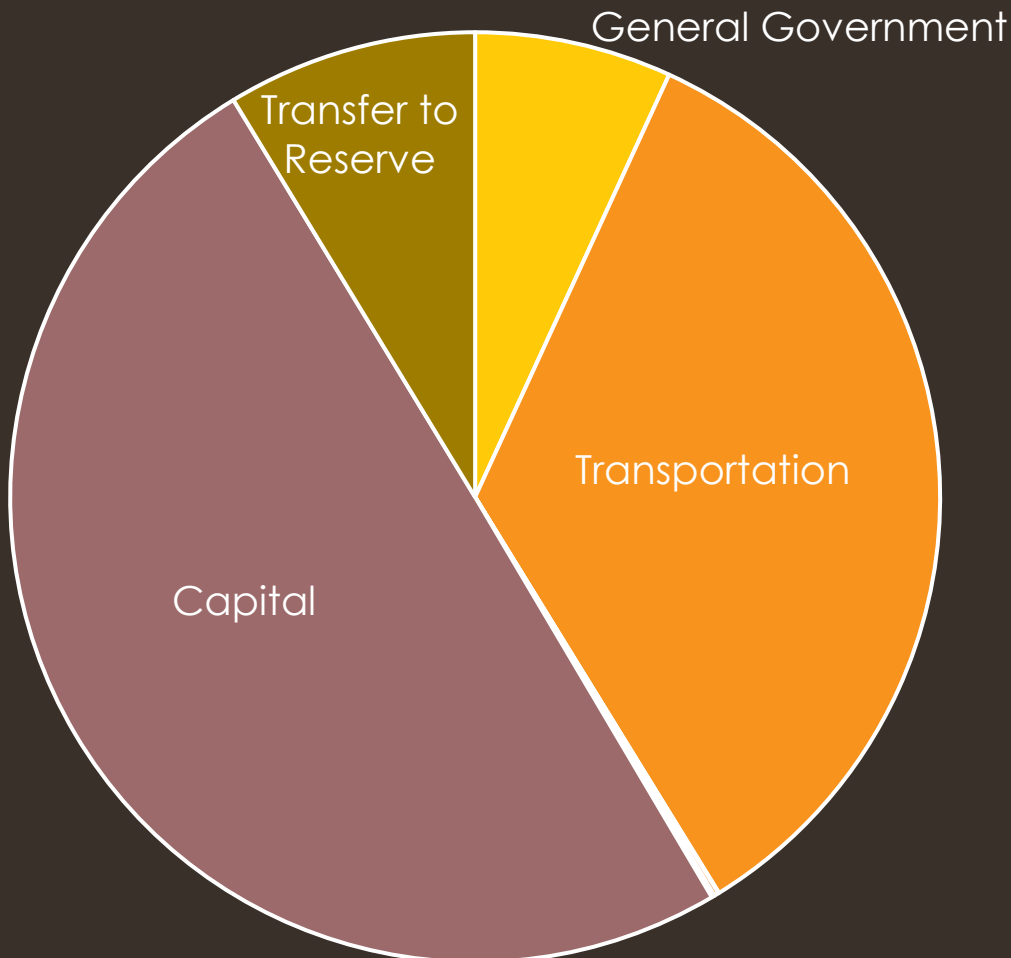

## Transportation Services - \$131,781

- Road/Street Maintenance \$67,182
- Sidewalk/Boulevard Maintenance \$2,401
- Ditches/Road Drainage \$11,973
- Street Cleaning \$6,096
- Snow Removal \$17,000
- Street Lighting \$26,377
- Traffic Services \$752

# LUD of Kleefeld

## LUD Assessment 2023-2025

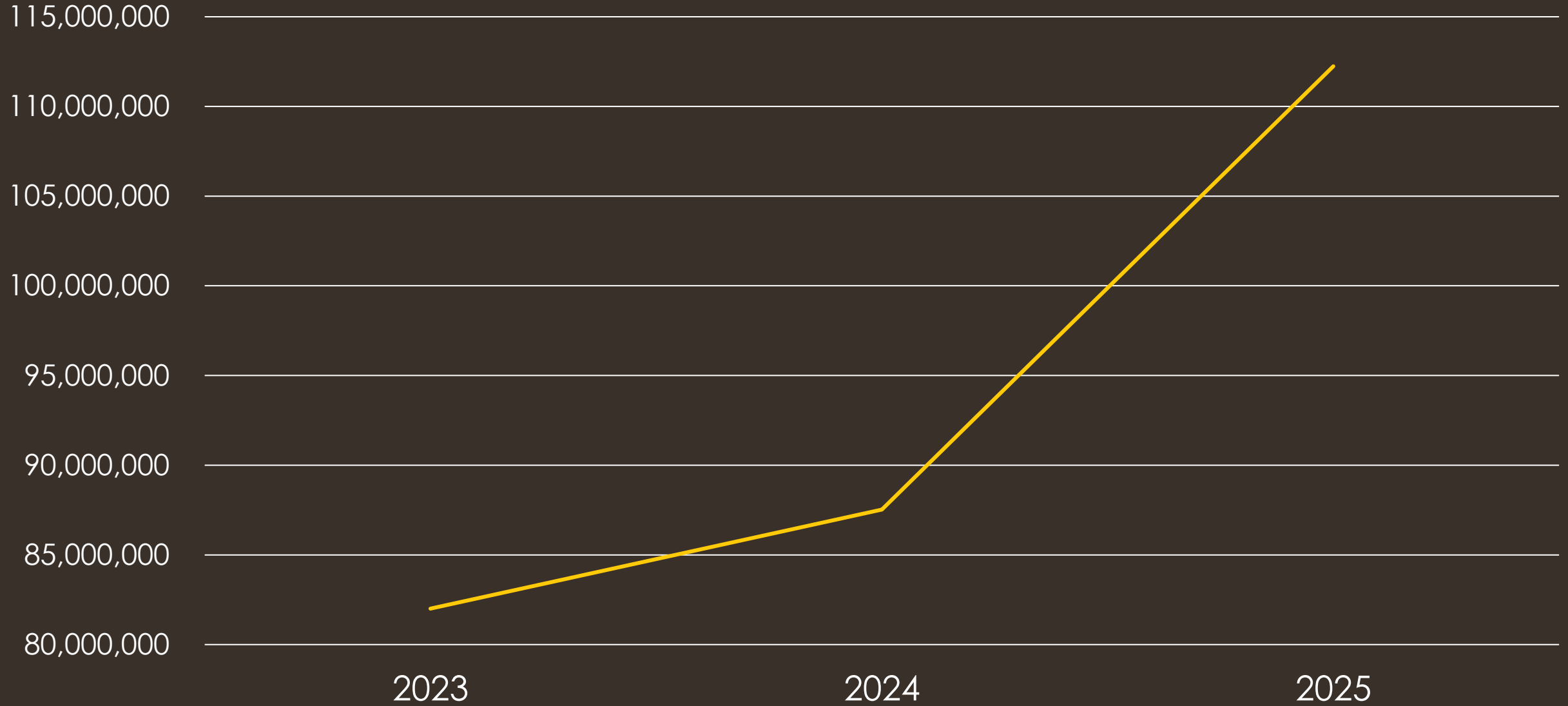

# LUD of Kleefeld

## LUD Taxes Raised 2023-2025

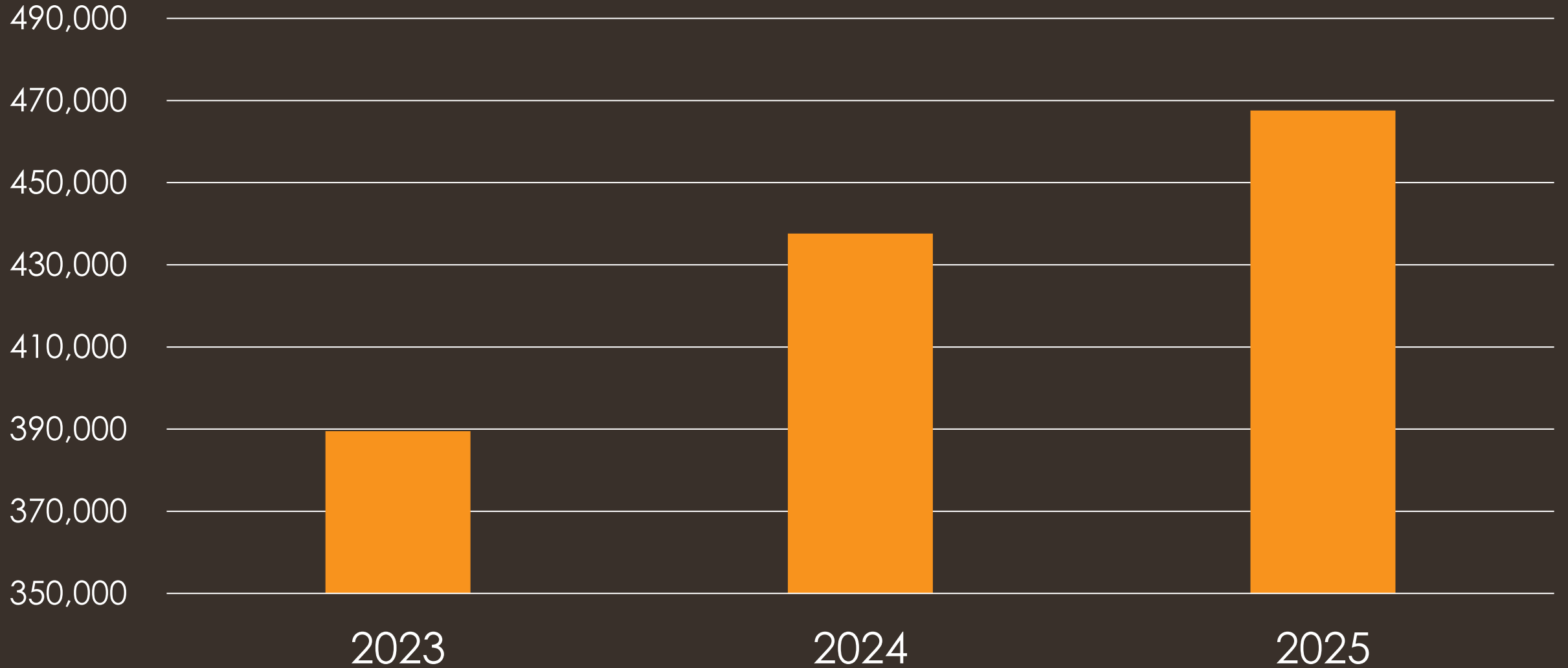

# LUD of Kleefeld

## 2025 Capital Plan

### Park Avenue Resurfacing and Culvert Replacement

Project Description: Remove Existing Asphalt, remove and replace damaged or poor graded Curb and Gutter, Remove and replace culverts and riprap, replace curb inlets, regrade and add base material, and apply new asphalt. **\$171,000**

### Deerpath Pathway

Project Description: Prepare base along existing granular pathway, install 1.5m wide Asphalt Pathway and landscape as required from Deerpath to Aspen Bay. **\$20,000**

### Ditching along Friesen Ave and Deerpath - \$8,973

### Kleefeld Utility

Second and Third Street Watermain Renewals – Project Description: Replace existing 50mm watermains with new 150mm watermains, install fire hydrants, new curb stops and service connections followed by boulevard and street repair as required.

# 2025 Reserve Balances

## LUD Reserve:

|                                       |   |                  |
|---------------------------------------|---|------------------|
| 2025 Beginning Balance at January 1   |   | \$282,159        |
| 2025 Reserve Withdrawal               | - | \$191,000        |
| 2025 Reserve Contribution at year end | + | \$323,373        |
| <b>2025 Projected Ending Balance</b>  |   | <b>\$414,532</b> |

LUD Sidewalk Reserve (from Developers' lot fees) \$29,939

LUD Greenspace Reserve (from Developers' lot fees) \$102,388

# LUD of Kleefeld

## Year-end Reserve Balance 2015-2025

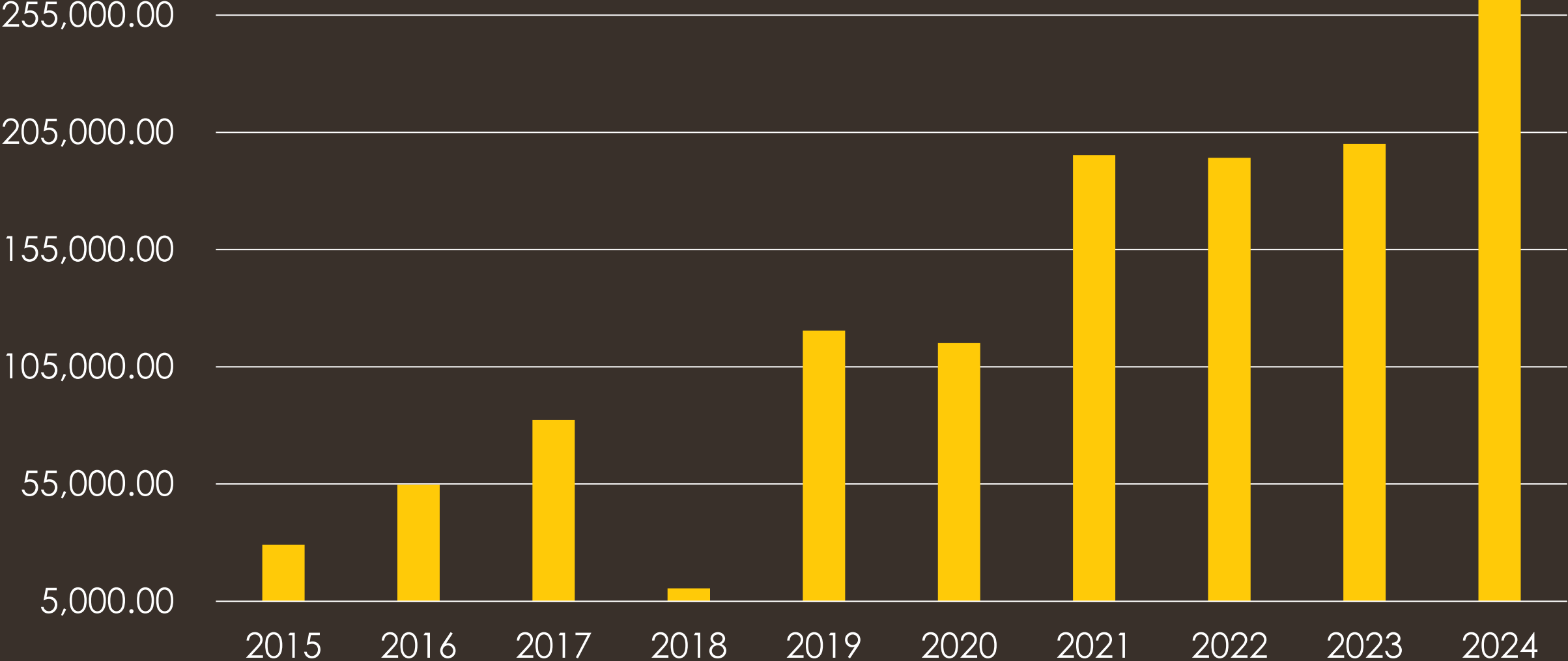

# COMPLETED PROJECTS

- Barkman and Barak  
Sidewalk project



# COMPLETED PROJECTS

## Happy Hive Daycare Construction



**COMPLETED  
PROJECTS  
PR216 Sidewalk  
fronting Fields  
Market**



# Completed Project – Drain and Walking Path



**Future Project**

**Future Deerpath  
pathway once  
Hydro relocates  
anchors**



# Compost SPRING SCHEDULE 2025

## MAY 2025

| Sun | Mon             | Tue | Wed | Thu                                       | Fri   | Sat |
|-----|-----------------|-----|-----|---|---|-----|
|     |                 |     |     | 1   | 2   | 3   |
| 4   | 5               | 6   | 7   | 8   | 9   | 10  |
| 11  | 12              | 13  | 14  | 15  | 16  | 17  |
| 18  | 19              | 20  | 21  | 22 GRUNTHAL CURBSIDE<br>MITCHELL CURBSIDE | 23 KLEEFFELD CURBSIDE<br>BLUMENORT CURBSIDE | 24  |
| 25  | 26 NEW BOTHWELL | 27  | 28  | 29 GRUNTHAL CURBSIDE<br>MITCHELL CURBSIDE | 30 KLEEFFELD CURBSIDE<br>BLUMENORT CURBSIDE | 31  |

## JUNE 2025

| Sun | Mon             | Tue | Wed | Thu                                       | Fri   | Sat |
|-----|-----------------|-----|-----|---|---|-----|
| 1   | 2 NEW BOTHWELL  | 3   | 4   | 5 GRUNTHAL CURBSIDE<br>MITCHELL CURBSIDE  | 6 KLEEFFELD CURBSIDE<br>BLUMENORT CURBSIDE  | 7   |
| 8   | 9 NEW BOTHWELL  | 10  | 11  | 12 GRUNTHAL CURBSIDE<br>MITCHELL CURBSIDE | 13 KLEEFFELD CURBSIDE<br>BLUMENORT CURBSIDE | 14  |
| 15  | 16 NEW BOTHWELL | 17  | 18  | 19 GRUNTHAL CURBSIDE<br>MITCHELL CURBSIDE | 20 KLEEFFELD CURBSIDE<br>BLUMENORT CURBSIDE | 21  |
| 22  | 23 NEW BOTHWELL | 24  | 25  | 26 GRUNTHAL CURBSIDE<br>MITCHELL CURBSIDE | 27 KLEEFFELD CURBSIDE<br>BLUMENORT CURBSIDE | 28  |
| 29  | 30 NEW BOTHWELL |     |     |   |   |     |

## JULY 2025

| Sun | Mon | Tue | Wed | Thu                  | Fri                   | Sat |
|-----|-----|-----|-----|----------------------|-----------------------|-----|
|     |     | 1   | 2   | 3 MITCHELL CURBSIDE  | 4 BLUMENORT CURBSIDE  | 5   |
| 6   | 7   | 8   | 9   | 10 MITCHELL CURBSIDE | 11 BLUMENORT CURBSIDE | 12  |

### COMMUNITY DEPOT

**New Bothwell**  
50 Park Bay  
(Community Center)

OPERATIONAL HOURS  
**5:00PM TO 8:00PM**  
PLEASE **DO NOT** LEAVE BAGS  
DURING NON-OPERATIONAL TIMES.

### CURBSIDE COMPOST COLLECTION

**L.U.D Mitchell THURSDAYS**

**L.U.D Grunthal THURSDAYS**

**L.U.D Blumenort FRIDAYS**

**NEW L.U.D Kleefeld FRIDAYS**

**CURBSIDE PICK UPS BETWEEN 7AM-7PM**  
NEED A GREEN BIN?  
CALL 204-346-7129 EXT 0  
EMAIL SOLIDWASTE@HANOVERMB.CA  
L.U.D RESIDENTS ONLY

# Compost FALL SCHEDULE 2025

## AUGUST 2025

| Sun | Mon | Tue | Wed | Thu                  | Fri                   | Sat |
|-----|-----|-----|-----|----------------------|-----------------------|-----|
| 24  | 25  | 26  | 27  | 28 MITCHELL CURBSIDE | 29 BLUMENORT CURBSIDE | 30  |
| 31  |     |     |     |                      |                       |     |

## SEPTEMBER 2025

| Sun | Mon             | Tue | Wed | Thu                                       | Fri   | Sat  |
|-----|-----------------|-----|-----|---|---|--|
|     | 1               | 2   | 3   | 4 MITCHELL CURBSIDE                       | 5 BLUMENORT CURBSIDE                        | 6  |
| 7   | 8 NEW BOTHWELL  | 9   | 10  | 11 GRUNTHAL CURBSIDE<br>MITCHELL CURBSIDE | 12 KLEEFFELD CURBSIDE<br>BLUMENORT CURBSIDE | 13   |
| 14  | 15 NEW BOTHWELL | 16  | 17  | 18 GRUNTHAL CURBSIDE<br>MITCHELL CURBSIDE | 19 KLEEFFELD CURBSIDE<br>BLUMENORT CURBSIDE | 20   |
| 21  | 22 NEW BOTHWELL | 23  | 24  | 25 GRUNTHAL CURBSIDE<br>MITCHELL CURBSIDE | 26 KLEEFFELD CURBSIDE<br>BLUMENORT CURBSIDE | 27 MITCHELL COMMUNITY DEPOT<br>130 ASH ST (ARENA)<br>9AM-3PM |
| 28  | 29 NEW BOTHWELL | 30  |     |   |   |  |

## OCTOBER 2025

| Sun | Mon             | Tue | Wed | Thu                                       | Fri   | Sat  |
|-----|-----------------|-----|-----|---|---|--|
|     |                 |     | 1   | 2 GRUNTHAL CURBSIDE<br>MITCHELL CURBSIDE  | 3 KLEEFFELD CURBSIDE<br>BLUMENORT CURBSIDE  | 4 MITCHELL COMMUNITY DEPOT<br>130 ASH ST (ARENA)<br>9AM-3PM  |
| 5   | 6 NEW BOTHWELL  | 7   | 8   | 9 GRUNTHAL CURBSIDE<br>MITCHELL CURBSIDE  | 10 KLEEFFELD CURBSIDE<br>BLUMENORT CURBSIDE | 11 MITCHELL COMMUNITY DEPOT<br>130 ASH ST (ARENA)<br>9AM-3PM |
| 12  | 13 NEW BOTHWELL | 14  | 15  | 16 GRUNTHAL CURBSIDE<br>MITCHELL CURBSIDE | 17 KLEEFFELD CURBSIDE<br>BLUMENORT CURBSIDE | 18 MITCHELL COMMUNITY DEPOT<br>130 ASH ST (ARENA)<br>9AM-3PM |
| 19  | 20 NEW BOTHWELL | 21  | 22  | 23 GRUNTHAL CURBSIDE<br>MITCHELL CURBSIDE | 24 KLEEFFELD CURBSIDE<br>BLUMENORT CURBSIDE | 25 MITCHELL COMMUNITY DEPOT<br>130 ASH ST (ARENA)<br>9AM-3PM |
| 26  | 27 NEW BOTHWELL | 28  | 29  | 30 GRUNTHAL CURBSIDE<br>MITCHELL CURBSIDE | 31 KLEEFFELD CURBSIDE<br>BLUMENORT CURBSIDE |  |

### COMMUNITY DEPOT

**New Bothwell**  
50 Park Bay  
(Community Center)

OPERATIONAL HOURS  
**5:00PM TO 8:00PM**  
PLEASE **DO NOT** LEAVE BAGS  
DURING NON-OPERATIONAL TIMES.

### CURBSIDE COMPOST COLLECTION

**L.U.D Mitchell THURSDAYS**

**L.U.D Grunthal THURSDAYS**

**L.U.D Blumenort FRIDAYS**

**NEW L.U.D Kleefeld FRIDAYS**

**CURBSIDE PICK UPS BETWEEN 7AM-7PM**  
NEED A GREEN BIN?  
CALL 204-346-7129 EXT 0  
EMAIL SOLIDWASTE@HANOVERMB.CA  
L.U.D RESIDENTS ONLY

# Garbage & Recycling 2025 SCHEDULE CHANGES



| Pick Up Area                          | Service being Interrupted | Original Date          | Date Change            |
|---------------------------------------|---------------------------|------------------------|------------------------|
| Grunthal                              |                           | Friday, April 18       | Monday, April 21       |
| Blumenort<br>Kleefeld<br>New Bothwell |                           | Tuesday, July 1        | Wednesday, July 2      |
| Mitchell                              |                           | Wednesday, July 2      | Thursday, July 3       |
| Grunthal                              |                           | Friday, July 4         | Monday, July 7         |
| Blumenort<br>Kleefeld<br>New Bothwell | <br>NO CHANGE FOR RECYCLE | Tuesday, September 30  | Wednesday, October 1   |
| Mitchell                              | <br>NO CHANGE FOR RECYCLE | Wednesday, October 1   | Thursday, October 2    |
| Grunthal                              | <br>NO CHANGE FOR RECYCLE | Friday, October 3      | Monday, October 6      |
| Blumenort<br>Kleefeld<br>New Bothwell | <br>NO CHANGE FOR GARBAGE | Tuesday, October 14    | Wednesday, October 15  |
| Mitchell                              | <br>NO CHANGE FOR GARBAGE | Wednesday, October 15  | Thursday, October 16   |
| Grunthal                              | <br>NO CHANGE FOR GARBAGE | Friday, October 17     | Monday, October 20     |
| Blumenort<br>Kleefeld<br>New Bothwell |                           | Tuesday, November 11   | Wednesday, November 12 |
| Mitchell                              |                           | Wednesday, November 12 | Thursday, November 13  |
| Grunthal                              |                           | Friday, November 14    | Monday, November 17    |
| Grunthal                              |                           | Friday, December 26    | Monday, December 29    |



## WHAT CAN BE Composted?



### Compostable

- ✓ Grass clippings
- ✓ Leaves
- ✓ Weeds (without seeds)
- ✓ Garden waste
- ✓ Peat moss
- ✓ Vegetables and fruits
- ✓ Coffee/filters, tea leaves/bags
- ✓ Egg shells
- ✓ Dead Flowers
- ✓ Compostable bags/Paper Bags



### Not Compostable

- ✗ Branches, wood chips or sawdust
- ✗ Herbicide-treated grass clippings
- ✗ Meat and bones
- ✗ Dairy products
- ✗ Perennial and seed-bearing weeds
- ✗ Pet manure
- ✗ Diseased plants
- ✗ Metal
- ✗ Plastic/Plastic Bags

### Community Compost Depot Info

DEPOTS ARE HELD ONCE PER WEEK BETWEEN 5:00 PM - 8:00 PM  
**DO NOT** LEAVE BAGS OUTSIDE HOURS OF OPERATION ABOVE.

### Curbside Compost Collection Info

ONLY COMPOST MATERIALS INSIDE THE BINS WILL BE COLLECTED.  
 NO ADDITIONAL BAGS/MATERIALS BESIDE BINS.  
 CONTENTS CAN ADDED TO THE BIN LOOSE OR IN COMPOST FRIENDLY BAGS.

**BINS AT THE ROAD BY 7:00AM**

**NO PLASTIC BAGS!**

# Garbage & Recycling SCHEDULE

| Pick Up Area                             | Day of the Week  |
|--|------------------|
| <b>BLUMENORT</b>                         | <b>TUESDAY</b>   |
| <b>KLEEFELD</b>                          | <b>TUESDAY</b>   |
| <b>ROSEVILLE DR, IVY RIDGE AREA</b>      | <b>TUESDAY</b>   |
| <b>MITCHELL AND AREA</b>                 | <b>WEDNESDAY</b> |
| <b>GRUNTHAL</b>                          | <b>FRIDAY</b>    |
| <b>SHADY LANE, GREEN ACRES LANE AREA</b> | <b>FRIDAY</b>    |

Schedule changes will be posted on our website, social media, and Community LED signs.



# *Timeline of the Kleefeld Water Utility*

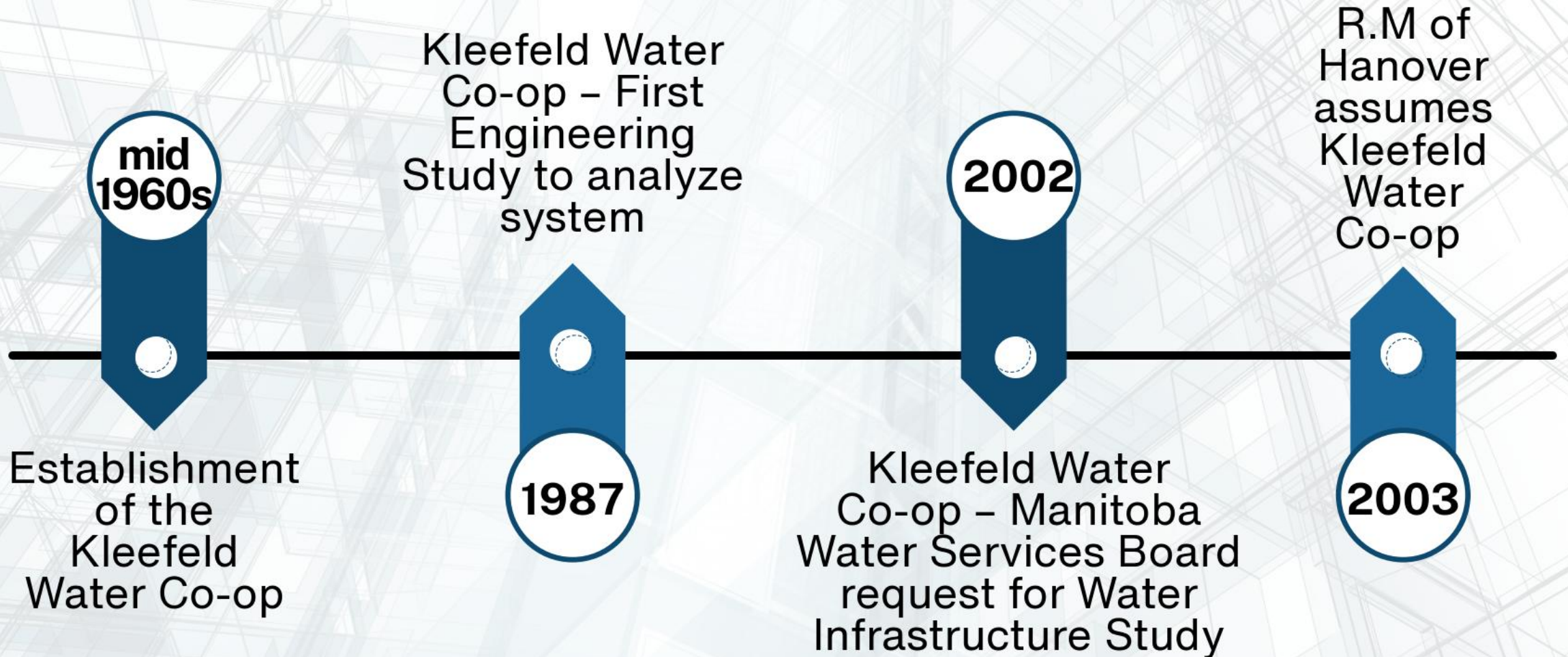



# *Timeline of the Kleefeld Water Utility*



New Water Plant  
and Reservoir  
Constructed  
\$1,500,000

**2010**

**2013**

Watermain  
Upgrades along  
College Avenue  
and 4<sup>th</sup> Street  
\$450,000

**2019**

Water Treatment Plant  
Upgrade with full UV  
Disinfection – Funding  
from Manitoba Water  
Services Board  
\$400,000



# Timeline of the Kleefeld Water Utility

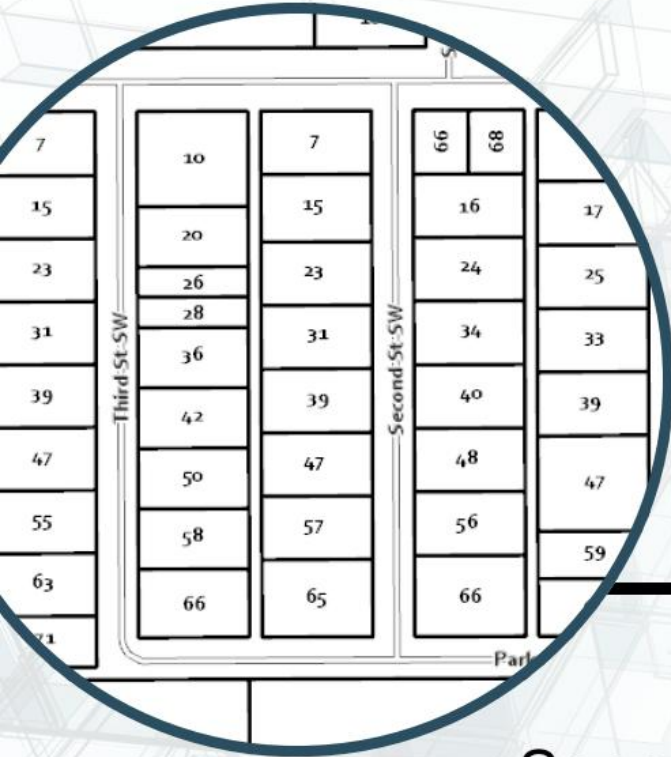

**2025**

Second and Third Street Watermain renewal project to remove the last 50mm lines in the community  
\$650,000

**2025**

Water Treatment Plant Engineering Proposal for Study and Design to upgrade current plant with full Filtration System to remove Iron, metals and ammonia  
\$140,000 with application for MWSB Funding

**2026 or future**

Construction of Water Treatment Plant Filtration System-  
\$2,000,000-  
\$2,500,000



# Cleaning Water Softeners & Hot Water Tanks

Cleaning water softeners and hot water tanks is essential to address yellowing water that may have built up in a home's plumbing system. Over time, mineral deposits, such as iron and calcium, can accumulate in these systems, leading to discolored water. Here's how to clean both systems effectively:

## Cleaning the Water Softener:

**Regenerate the system:** Run a manual regeneration cycle on the water softener to flush out built-up minerals.

**Clean the resin tank:** For more stubborn buildup, use a cleaning solution specifically designed for water softeners, or a mixture of bleach and water (consult the manufacturer's instructions). This helps remove iron and other contaminants.

**Rinse thoroughly:** After using the cleaning solution, ensure that the resin tank is thoroughly rinsed to prevent any chemicals from affecting the water quality.

## Cleaning the Hot Water Tank:

**Turn off the power and water supply:** To safely clean your hot water tank, first shut off the power (for electric heaters) or gas supply (for gas heaters), and turn off the water supply.

**Drain the tank:** Attach a hose to the drain valve and let the tank fully drain. This helps flush out any sediment and minerals that may be causing discoloration.

**Clean the tank:** For deeper cleaning, use a long brush to scrub the interior, particularly if there's visible buildup. You can also add a descaling agent or vinegar to help remove mineral deposits.

**Flush and refill:** Once the tank is cleaned, close the drain valve, open the water supply, and allow the tank to refill. Check for leaks or any remaining sediment.

By regularly cleaning these systems, you can significantly reduce yellowing water caused by mineral buildup, improving both water quality and the efficiency of your plumbing.

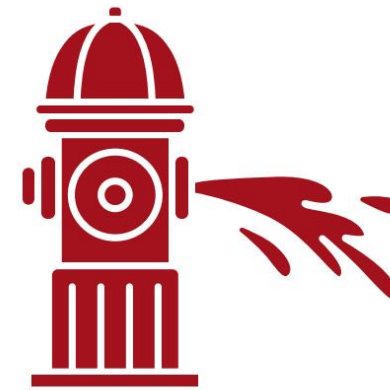

## Monthly Water Main Flushing

Water main flushing in Kleefeld will resume starting in May on the **2<sup>nd</sup> Wednesday & Thursday** of the month until freeze up.

# OPTIONAL

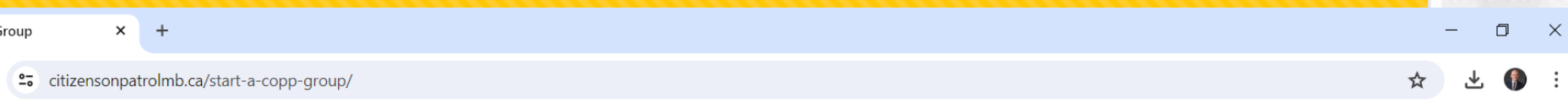
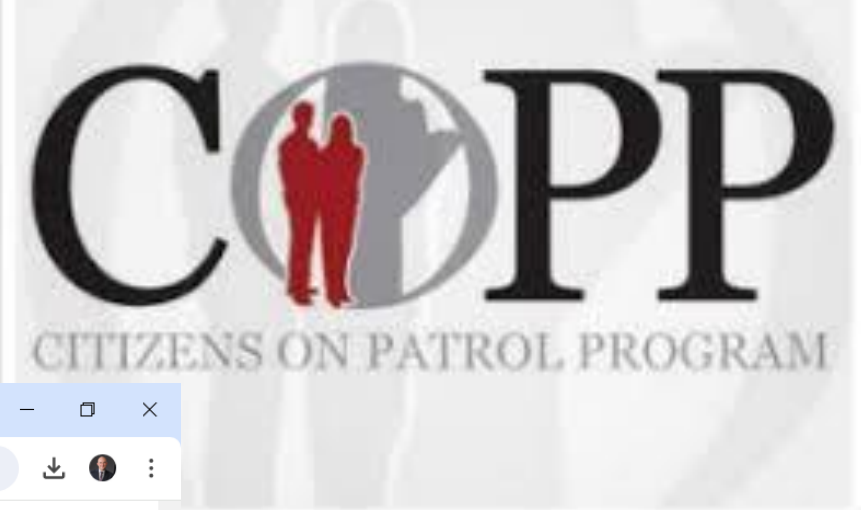

## Establishing Citizens On Patrol Program In Your Community

Community members play a crucial role in COPP. The program would not exist without their support and dedication.

Any individuals or groups who identify a safety concern in their community can consider establishing a local COPP group and can apply to join the provincial program.

Manitoba COPP will provide groups with support and resources, including the necessary equipment and training to establish their COPP group.

### How To Start And Run A COPP Group (Overview)

- Contact the Manitoba COPP or your local law enforcement office for direction and support. A Regional Representative may be available to come and talk to anyone interested in COPP.
- After a community meeting and/or reading all the information, if the group decides to organize the program, they will need to receive approval from their local law enforcement agency to start the group



# SEINE RAT ROSEAU

WATERSHED DISTRICT

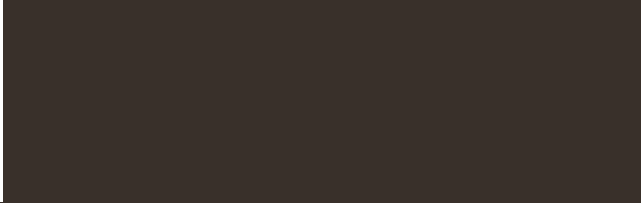

## Rain Gardens

The SRRWD Rain Garden program provides funding and design support to property owners who wish to implement a rain garden to capture surface water runoff, rainwater, or sump pump discharge. A rain garden is a perennial garden planted in a shallow depression designed to capture and use water that may otherwise runoff. Rain gardens do NOT create standing pools of water but rather are a designated place for water to infiltrate into the ground (generally within 24 – 48 hrs of a rain event). The SRRWD will provide up to \$5,000.00 (50% cost-share) for schools and public spaces to establish a rain garden. We also provide grants of \$750.00 to homeowners who establish a rain garden on their property.

# Planning Department

## Development Plan & Zoning By-Law Review

- Why review the Development Plan & Zoning By-Law?
  - Under the authority of The Planning Act, The Province of Manitoba requires municipalities to review their Development Plans on a regular basis, usually every 5 years.
  - Due to Hanover's consistent growth, a regular review is important to ensure the Municipality is growing and developing in a sustainable manner.
- When was the last review?
  - The Municipality commenced the last development plan review in 2016.
  - Current Development Plan & Zoning By-Law were adopted on March 13, 2019
- Who is conducting the review?
  - The Municipality has contracted Landmark Planning & Design Inc to spearhead this initiative.
- What is the cost?
  - The project is estimated to cost up to \$90,000. The Municipality has applied for a grant under the "From the Ground Up – Safe Healthy Communities For All" program with hopes of receiving up to 50% funding

- How long will this project take?
  - The total project is anticipated to take between 18-24 months. See the below outline.

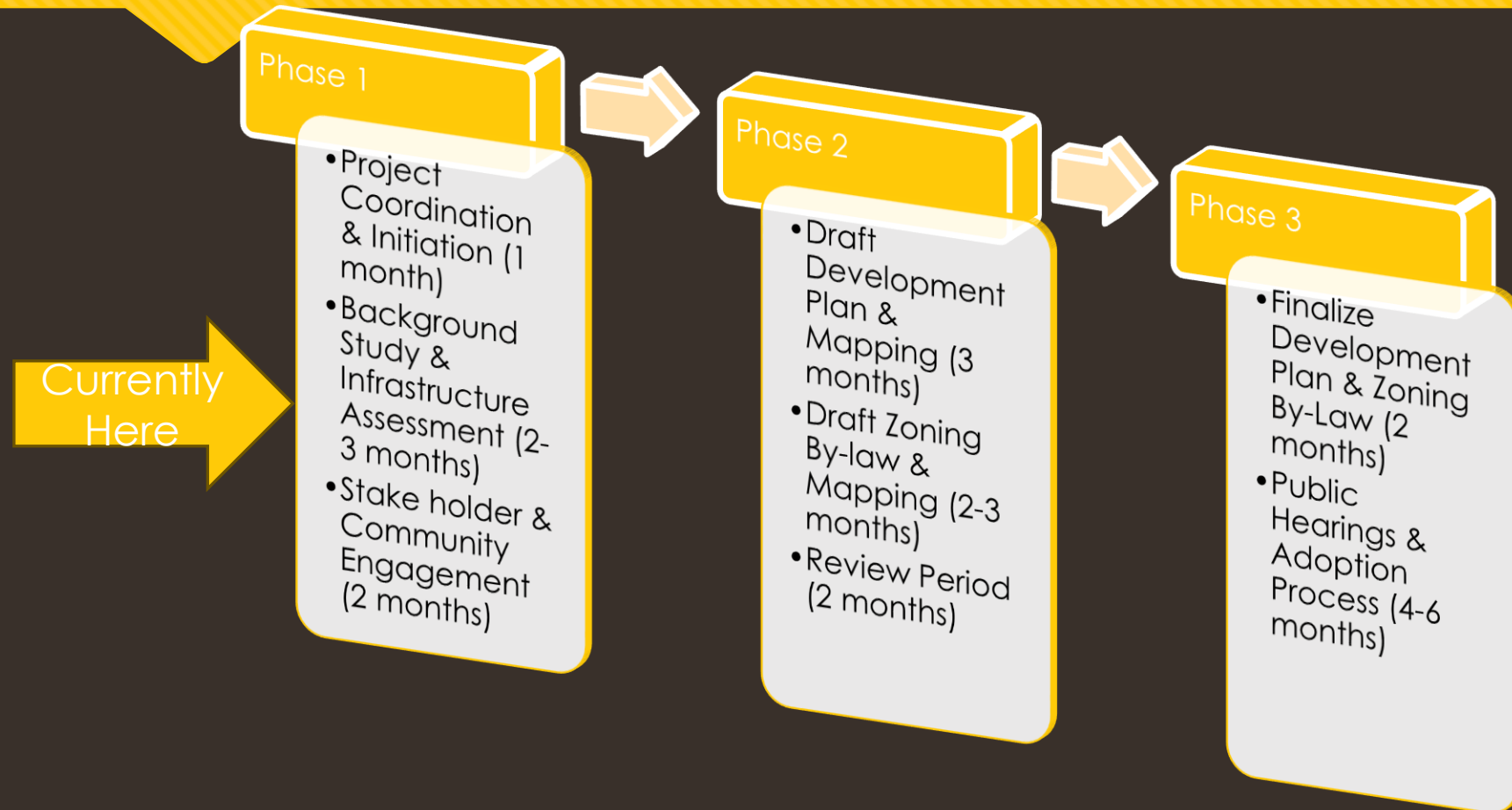

Note: some tasks may occur concurrently with others

# Proposed Developments in Kleefeld



# *Growth of Wastewater Capacity in Manitoba*

An Introduction to RSR Wastewater Cooperative



# Who is RSR?

- RSR is the Red-Seine-Rat Wastewater Cooperative, a group of 6 municipalities in southeastern MB that have banded together to provide a regional solution to the restrictions to growth that current wastewater facilities have caused.
- RSR was originally formed in 2019 between 4 municipalities: the RM's of Hanover, Ritchot, and Tache, as well as the Town of Niverville.
- In 2024, RSR was further joined by two other members: the RM of La Broquerie and the communities of Otterburne & Providence University College inside the RM of De Salaberry.
- RSR will, once completed, provide wastewater treatment to service 12,600 new housing units, or a rough population total of 101,000.
- Over 90km of new pipeline will be build to connect current wastewater treatment in the associated communities to the new treatment facility.





# ENHANCING RECREATION IN HANOVER

**A New Recreation Delivery System  
and Evolving Committee Roles**



01

WHY CHANGE  
WAS NEEDED.

02

OVERVIEW OF  
NEW  
RECREATION  
DELIVERY SYSTEM.

03

HOW THIS  
BENEFITS THE  
COMMUNITY  
AND  
VOLUNTEERS.

INTRODUCTION & PURPOSE

**Operations/Maintenance shifted to RM of Hanover.**

- **Grass Cutting, Parks and Playground Maintenance, Splash Pad, Sport Fields, Outdoor Rink and Skating Trails.**
- **Unified Parks/Capital Budgets and Operations.**

**Community Rec Committee will oversee:**

- **Programming, Community Events, assist in future visioning and planning.**
- **Community: Small Committees, more defined roles.**

# WHAT'S CHANGING



### **3 Community Members + 1 LUD Member + Councilor**

\*\*\*Committees currently larger than 3 members can continue to operate as they are currently. When terms expire, and members are departing, new committee size will be established.



### **Nomination process to fill openings.**

Council will appoint committees based on nominations.



### **Meeting Frequency: 4-6 times per year**



### **Key Focus Areas:**

***Community Programming***  
***Special Events***  
***Visioning and Planning*** for future needs.

# RECREATION COMMITTEE STRUCTURE AND RESPONSIBILITIES

- ▶ Operations and Maintenance
  - ▶ Staffing.
  - ▶ Maintenance of Parks, Greenspaces, Playgrounds, Splashpads, Sport Fields/Diamonds, Outdoor Skating including ODR's and Skating trails, toboggan slide etc.
  - ▶ Patron Feedback available through barcode scan.
  - ▶ Facility Rentals, invoicing, program registrations, payments.

# RECREATION AND COMMUNITY SERVICES DEPARTMENT (HANOVER)



- ▶ Less Burden on Volunteers.
- ▶ More community-driven programming.
- ▶ Efficient and focused meetings.
- ▶ Flexible Schedules (including virtual options possible based on need).
- ▶ Enhanced ability for Hanover to consider larger capital projects by pooling resources.
- ▶ More efficient use of resources, including staff and equipment between communities.

## BENEFITS OF NEW MODEL



Community nominations for open committee spots – Spring 2025.

- Council Selection of new committee members (where required).

Training and Onboarding for new committee members – June 2025.

Transition period for new roles and responsibilities

## NEXT STEPS AND IMPLEMENTATION TIMELINE



## KLEEFELD DAY CARE PROJECT

# 2024 CAPITAL PROJECT RECAP



## 2025 CAPITAL PROJECTS

- ▶ **Kleefeld ODR Refresh**
  - ▶ **New board system will be installed in the summer of 2025 to give the ODR an upgrade prior to the 2025/2026 Winter Season.**

## **Volunteers**

- Riley Friesen (Chair)
- Austin Plett
- Laura Simpson
- Brianne Forsyth
- Rosie Winter
- Linda McKenzie

LUD – Travis Fehr

Council – Darrin Warkentin

# KLEEFELD RECREATION COMMITTEE

# 2025 EVENTS & PROGRAMMING

**Community Clean Up – May 3rd**

**3<sup>rd</sup> Annual Car Show – June 7**

**Honey Festival – August**

- Signature Festival
- Community Breakfast, Family Activities, Food, Fireworks!

**Santa Parade – Nov 21**

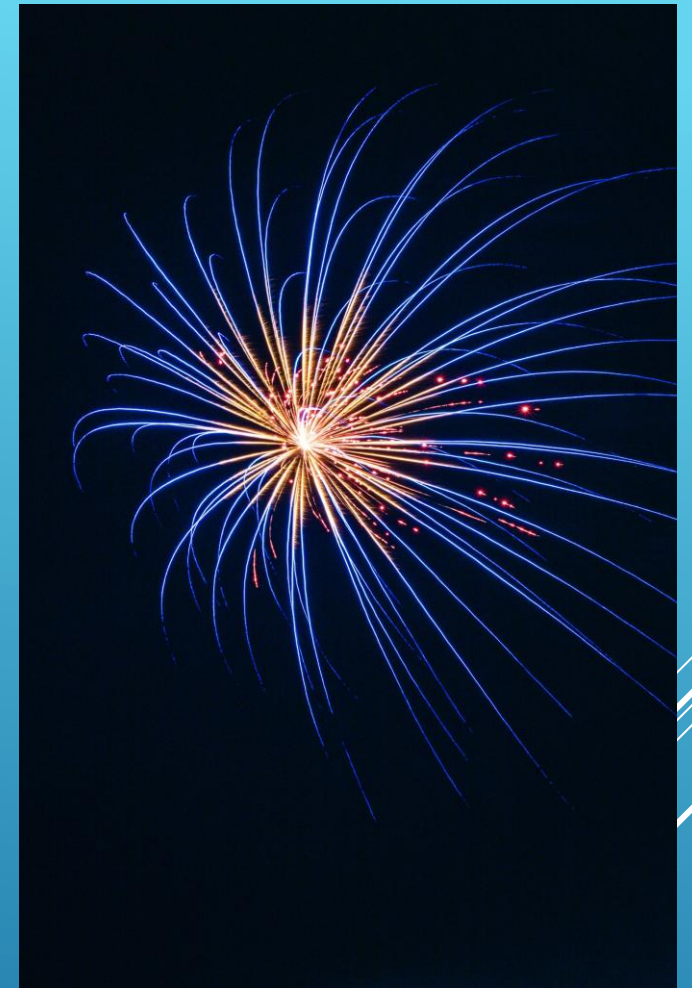

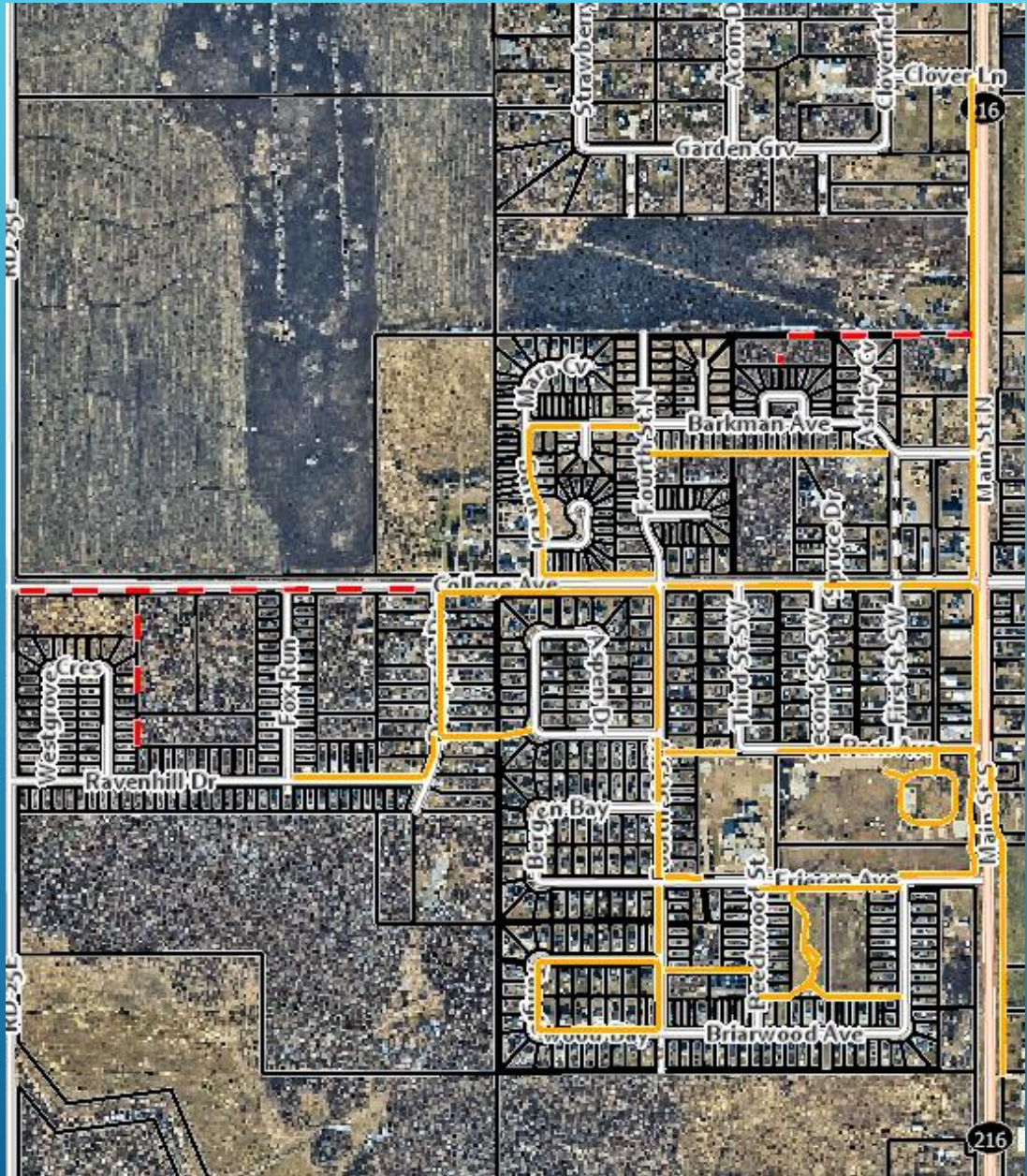

# ACTIVE TRANSPORTATION NETWORK

EXISTING  
FUTURE/PLANNED

QUESTIONS OR COMMENTS

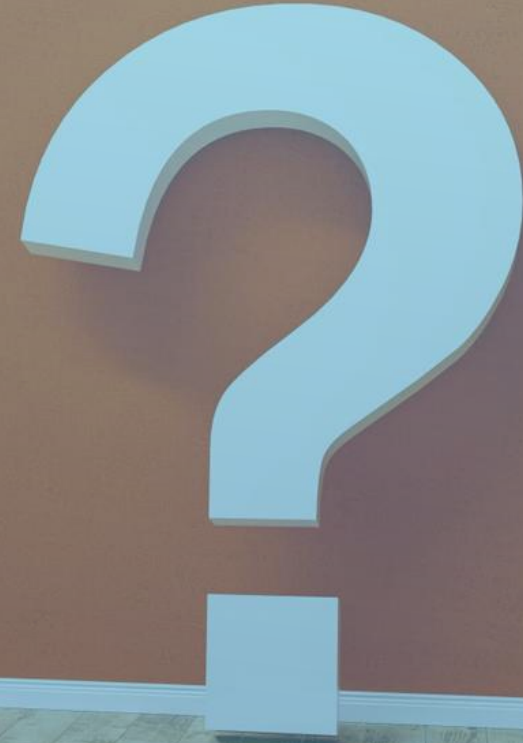



# eNEWS



## HAVE YOU HEARD?

STAY UP TO DATE ON HANOVER ENEWS BY SUBSCRIBING TO OUR MONTHLY NEWSLETTER!

ALL **CURRENTLY REGISTERED SUBSCRIBERS ALONG WITH THE NEW ONES** WILL HAVE A CHANCE TO WIN ONE OF THREE HANOVER-OWNED RECREATIONAL CENTRE HALL RENTALS AT THE LOCATION OF THEIR CHOICE. DRAWS WILL TAKE PLACE IN MAY 2025.

**SUBSCRIBE ON OUR WEBSITE TODAY!**

**[WWW.HANOVERMB.CA/P/SUBSCRIBE](http://WWW.HANOVERMB.CA/P/SUBSCRIBE)**

**FREE DRAW SIGN UP NOW**





# eNEWS

**FREE DRAW SIGN UP NOW**

**WWW.HANOVERMB.CA**



# STAY IN THE LOOP

Want to stay up to date with what's happening in your community?

Follow us on our social media pages!



**RuralMunicipalityofHanover**  
**RMofHanoverRecreation**



**@rmofhanover**  
**@rmofhanoverrecreation**



# eNEWS

**FREE DRAW SIGN UP NOW**

**WWW.HANOVERMB.CA**



# STAY IN THE LOOP

Want to stay up to date with what's happening in your community?

Follow us on our social media pages!



**RuralMunicipalityofHanover  
RMofHanoverRecreation**



**@rmofhanover  
@rmofhanoverrecreation**



# eNEWS

April 2025



## CONTACT INFO

28 Westland Dr, Mitchell MB R5G 2N9

204.326.4488

general@hanovermb.ca

www.hanovermb.ca

**GREAT PLACE  
TO LIVE,  
WORK & PLAY**

## STAY IN THE LOOP

Want to stay up to date with what's happening in your community? Follow us on our social media pages!



RuralMunicipalityofHanover  
RMofHanoverRecreation



@rmofhanover  
@rmofhanoverrecreation

## CONNECTIONS

### Reeve

Jim Funk 204.371.2737, jim.funk@hanovermb.ca



### Councillors

Travis Doerksen (Ward 1) 204.371.1949, travis.doerksen@hanovermb.ca

Brian Esau (Ward 2) 204.326.8504, brian.esau@hanovermb.ca

Roberto Hiebert (Ward 3) 204.392.8544, roberto.hiebert@hanovermb.ca

Ed Penner (Ward 4) 204.326.8515, ed.penner@hanovermb.ca

Darrin Warkentin (Ward 5) 204.346.3077, darrin.warkentin@hanovermb.ca

Curtis Dawydiuk (Ward 6) 204.371.2950, curtis.dawydiuk@hanovermb.ca

### CAO

Luc Lahaie 204.371.9881, luc.lahaie@hanovermb.ca

## UPCOMING COUNCIL MEETINGS

Apr. 9, 2025 - 9:00 a.m.

Apr. 23, 2025 - 4:00 p.m.

May 14, 2025 - 9:00 a.m.

May 21, 2025 - 4:00 p.m.



# CHIEF ADMINISTRATIVE OFFICER

## Contact Information:

luc.lahaie@hanovermb.ca or 204.371.9881

# FINANCE & ADMINISTRATION

## Contact Information:

general@hanovermb.ca or 204.326.4488; finance@hanovermb.ca

## NEW BOTHWELL



### LOTS ARE FULLY SERVICED WITH:

- 3 PHASE ELECTRICITY
- NATURAL GAS
- LOW PRESSURE SEWER
- CO-OP WELL
- ASPHALT SERVICE ROAD
- CURBS & GUTTERS
- STREET LIGHTS

**NOW SELLING**  
**LIGHT INDUSTRIAL LOTS**  
**STARTING AT**  
**\$145,900.00**

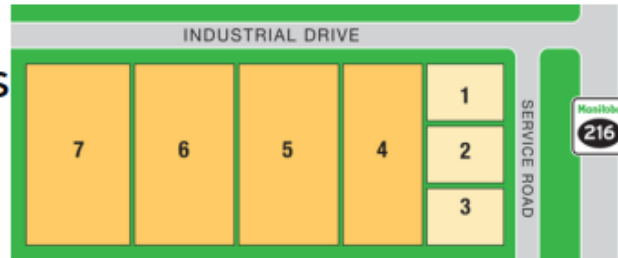

**MICHELLE HARTIN**  
**REALTOR®**  
**204-746-5850**  
**HELPFULHARTIN@GMAIL.COM**

**2025 Financial Plan hearing is scheduled for**  
**Wednesday, April 23, 2025 at 4:45 in the**  
**Council chambers at our main office at**  
**28 Westland Drive.**

**The hearing is open to the public and residents**  
**are encouraged to attend if they have questions**  
**about planned services and projects for 2025.**



## ACCEPTED PAYMENT METHODS

**CASH**   **CHEQUE**   **DEBIT CHECK DAILY LIMIT!**  
**CREDIT CARD FEES APPLY**   **IN-PERSON OR ONLINE**  
**ONLINE BANKING**   **DROP BOX**



**Upcoming**  
**Office**  
**Closures:**

April 18, 2025  
 May 19, 2025  
 July 1, 2025  
 August 4, 2025  
 September 1, 2025  
 September 30, 2025  
 October 13, 2025  
 November 11, 2025

# PLANNING & PERMITS

## Contact Information:

planning@hanovermb.ca or 204.346.7126; permits@hanovermb.ca or 204.346.7125

Hanover is on track to outperform 2025 in residential construction. The total value of permits issued to date is \$8.2 million; with a year over year increase of 39% in the number of new units permitted or under construction. Year to date, Hanover's total permits value is up 18% from approx. \$9.5 million in 2024 to \$11.2 million in 2025.

Please visit [www.hanovermb.ca](http://www.hanovermb.ca) for more information.



Building permit holders should keep in mind that road restrictions are now in effect until May 29, 2025 unless otherwise posted on website: [www.hanovermb.ca](http://www.hanovermb.ca).

# WORKS & OPERATIONS

## Contact Information:

worksandoperations@hanovermb.ca or 204.346.7129



## BOULEVARD & STREET SWEEPING

**SCHEDULES WILL BE POSTED SOON!**  
CHECK OUR WEBSITE, SOCIAL MEDIA, & LED SIGNS FOR DATES

COMING SOON  
TO KLEEFELD

*curbside composting*



The LUD of Kleefeld is making a change to compost collection by rolling out automated Curbside Compost bins! These bins will replace the community compost depot and offer the optional, weekly service to residential properties, right at your curb instead!

Curbside Compost will be collected in Spring every **Friday** starting **May 23rd** up to and including **June 27th** just like garbage and recycling is collected. Compost collection will resume again in Fall.

A flyer with more details will be included in your quarterly utility bill.

# ENGINEERING & UTILITIES

## Contact Information:

utilities@hanovermb.ca or 204.346.7129

Cleaning water softeners and hot water tanks is essential to address yellowing water that may have built up in a home's plumbing system. Over time, mineral deposits, such as iron and calcium, can accumulate in these systems, leading to discolored water. Here's how to clean both systems effectively:

### Cleaning the Water Softener:

**Regenerate the system:** Run a manual regeneration cycle on the water softener to flush out built-up minerals.

**Clean the resin tank:** For more stubborn buildup, use a cleaning solution specifically designed for water softeners, or a mixture of bleach and water (consult the manufacturer's instructions). This helps remove iron and other contaminants.

**Rinse thoroughly:** After using the cleaning solution, ensure that the resin tank is thoroughly rinsed to prevent any chemicals from affecting the water quality.

### Cleaning the Hot Water Tank:

**Turn off the power and water supply:** To safely clean your hot water tank, first shut off the power (for electric heaters) or gas supply (for gas heaters), and turn off the water supply.

**Drain the tank:** Attach a hose to the drain valve and let the tank fully drain. This helps flush out any sediment and minerals that may be causing discoloration.

**Clean the tank:** For deeper cleaning, use a long brush to scrub the interior, particularly if there's visible buildup. You can also add a descaling agent or vinegar to help remove mineral deposits.

**Flush and refill:** Once the tank is cleaned, close the drain valve, open the water supply, and allow the tank to refill. Check for leaks or any remaining sediment.

By regularly cleaning these systems, you can significantly reduce yellowing water caused by mineral buildup, improving both water quality and the efficiency of your plumbing.

# ENGINEERING & UTILITIES

## Contact Information:

utilities@hanovermb.ca or 204.346.7129



## Monthly Water Main Flushing

Water main flushing in Kleefeld and Grunthal will resume in May.

**Kleefeld: 2nd Wed/Thurs**

**Grunthal: 3rd Wed/Thurs**

## QUARTERLY UTILITY BILLS for Grunthal/Kleefeld



Quarterly utility bills for Kleefeld and Grunthal will be sent out after April 1 with a due date of April 30, 2025.

## ANNUAL SEWER USER BILLS for Blumenort, Mitchell & New Bothwell

Annual sewer user bills will be sent out in April/May and will be due the same time as property taxes,

**October 17, 2025.**





**Fire Chief**  
204.346.7130  
paul.wiebe@hanovermb.ca



## GRUNTHAL FIRE DEPARTMENT ANNUAL SPRING SUPPER & SILENT AUCTION

SATURDAY APRIL 12, 2025 | 5:30 PM  
GRUNTHAL FIRE DEPARTMENT

(FUNDS WILL ALSO BE USED TO SUPPORT OUR SCHOLARSHIP FOR HIGH SCHOOL STUDENTS THAT WISH TO ATTEND FIRE COLLEGE)

# REMINDER

**Burning of leaves and sticks  
is prohibited in towns and rural  
residential areas!!**

BY-LAW NO. 2523-22



**Fire Chief**  
204.346.7130  
paul.wiebe@hanovermb.ca

## Emergency Operations Centre (EOC) Volunteer Opportunities



RM of Hanover has a volunteer based Emergency Operations Centre (EOC) Team that is led by the Emergency Operations Coordinator, Paul Wiebe, RM of Hanover Fire Chief.

In the event of an emergency, the Emergency Operations Centre will be activated to support residents in accordance with the RM of Hanover's Emergency Plan. The Emergency Operations Centre Team convenes about four times annually to assess the emergency plan and prepare for potential crises.

If you are interested in becoming part of this team, please contact Paul Wiebe by e-mail [paul.wiebe@hanovermb.ca](mailto:paul.wiebe@hanovermb.ca) for available positions.

Community Safety Officer  
204.346.7131  
cso@hanovermb.ca



## SPRING ROAD RESTRICTIONS ARE IN EFFECT

AS OF **6:00 A.M. TUESDAY, MARCH 25, 2025**

CONTINUING UNTIL

**11:59 P.M. ON THURSDAY, MAY 29, 2025\***

The Rural Municipality of Hanover has posted certain roads at 65% of the normal axle loading's on B1 Municipal roads.

Roads that are restricted are appropriately signed and restrictions will continue until signs are removed.

Map with affected roads can be found on our website.

<https://maps.hanovermb.ca/Viewer/index.html?viewer=RoadRestrictions>



The fines for non-compliance will be based on the weight over the allowable limit. The bylaw states, **\$25 fine for every 50kg** that a load is overweight.

**Questions or Concerns, contact the Community Safety Officer**

(info above)



## BLUMENORT

Kevin Medeiros 204.371.6309  
Roger Dueck 204.392.4564  
Floyd Penner 204.392.2713

On March 31, the Local Urban District (LUD) of Blumenort hosted our annual general meeting, where we had the opportunity to share our 2025 service plan and gather valuable feedback from residents. Some of the upcoming projects that we are excited to announce include:

- New sidewalk installation along Crestview and Edgemont to improve pedestrian safety and accessibility.
- Re-surfacing of Parkview Bay to enhance road conditions and ensure smoother travel.
- A brand-new dog park in the green space off Harvest Bay, providing a dedicated area for our four-legged friends to play and socialize.
- A new walking path around the retention pond on Stoney Creek Drive.
- Various asphalt repairs throughout town to maintain and improve road quality.

*Thank you for making our Community Service Plan meeting a success. We look forward to another productive year of community improvements.*





**GRUNTHAL**

Anita Funk 204.371.9134  
Thomas Guenther 204.392.9216  
Paul Perreault 204.371.6665

# Grunthal Community Service Plan MEETING



**APRIL 7, 2025  
7:00 P.M.**

**NEW HORIZON SENIOR CENTRE**



**Grunthal Community Clean Up Friday, May 2nd  
Meet at the Grunthal DropZone at 6 p.m.  
Dress for the weather.  
Barbecue to follow.**



**HELP KEEP YOUR COMMUNITY CLEAN!**



**GRUNTHAL**



# Calling all Candidates...

**The registration period for the  
2025 LUD of Grunthal by-election  
is open!**

**RM of Hanover is accepting candidate  
registration for the position of LUD of Grunthal Member.**

**Nomination Deadline:  
April 15, 2025 @ 4pm**

For more information  
on running for LUD of Grunthal Committee visit  
[www.hanovermb.ca/p/2025-lud-of-grunthal-by-election](http://www.hanovermb.ca/p/2025-lud-of-grunthal-by-election)  
All inquiries: [SEO@hanovermb.ca](mailto:SEO@hanovermb.ca) or  
Call Senior Elections Officer: Lois Gresiu 204.392.2173



# LUD OF GRUNTHAL BY-ELECTION DAY

## Wednesday, May 21st, 2025

8:00 am - 8:00 pm

Grunthal Arena Lobby  
63 Albert Avenue

For more information regarding  
the municipal election visit  
[www.hanovermb.ca/](http://www.hanovermb.ca/)



Dawn Oude Voshaar 204.377.4830  
Randy Peters 204.371.9696  
Travis Fehr 204.371.1357

## Kleefeld Community Service Plan MEETING

APRIL 8, 2025

7:00 P.M.

KLEEFELD

RECREATION CENTRE



THIS IS YOUR OPPORTUNITY TO GET INVOLVED,  
STAY INFORMED, AND SHARE YOUR IDEAS FOR  
MAKING YOUR COMMUNITY EVEN BETTER!





MITCHELL

Brad Kehler 204.326.9583  
Tim Fehr 204.392.6127  
Cliff Froese 204.905.4056

# Mitchell Community Service Plan MEETING



APRIL 1, 2025  
7:00 P.M.  
MITCHELL  
RECREATION CENTRE



## MITCHELL COMMUNITY SPRING CLEAN UP

SATURDAY, MAY 3  
9:00 A.M. - 12:00 NOON  
LUNCH FOR ALL VOLUNTEERS!  
HELP KEEP YOUR  
COMMUNITY CLEAN!



NEW  
BOTHWELL

Ernest Kehler 204.392.0645  
Irma Friesen 204.388.6293  
Rob Hiebert 204.371.1216

# New Bothwell Community Service Plan MEETING

APRIL 3, 2025  
7:00 P.M.  
NEW BOTHWELL  
RECREATION CENTRE



THIS IS YOUR OPPORTUNITY TO GET INVOLVED,  
STAY INFORMED, AND SHARE YOUR IDEAS FOR  
MAKING YOUR COMMUNITY EVEN BETTER!

# RECREATION ENEWS



## Upcoming Programs:

This year's Blumenort Summer Camp theme is "I Rock! Digging into Adventure"! Campers will enjoy exciting activities, including splashing around at the Blumenort Splash Pad, with a special one-time morning tour of a Fast Brothers gravel pit!

# RECREATION ENEWS



## Upcoming Programs:

Mitchell Soccer  
Registration opens: March 4 at 8:00 a.m.  
Deadline: **April 3 at 11:55 p.m.**  
PreK-K: Tuesdays 5:30-6:15 p.m.  
Grades 1-4: Tuesdays, 6:30-7:30 p.m.  
PreK-K is full, but the waitlist is open!



## Upcoming Programs:

Swimming Lesson Registration is OPEN! Register online today at the RM of Hanover Website: Parks & Recreation > Register for a Program

## Upcoming Events:

Mark your calendar for **April 26!** Starting at 5:00 PM, join us for the Arena Renewal Fundraiser! Enjoy great food and top-notch entertainment. Tickets can be bought at **Grunthal Lumber, Grunthal Grocery,** and the **RM of Hanover Office!** You won't want to miss it!



## Upcoming Programs:

Don't forget to sign up for Toddler Shenanigans!  
Happening every other Saturday from 10:00-11:00 a.m.  
Have you heard? New Bothwell Soccer is back!  
Registration opens: March 4 at 8:00 a.m.  
Deadline: **April 3 at 11:55 p.m.**  
Ages 5-12 | Mondays, 6:30-7:30 p.m.



## Upcoming Programs:

Kleefeld Soccer  
Registration opens: March 4 at 8:00 a.m.

Deadline: **April 3 at 11:55 p.m.**

PreK-Gr. 6: Tuesdays & Thursdays 7:00-8:00 p.m.  
PreK-K and Gr. 1-2 are full, but the waitlist is open!



## Share Your Input!

The RM of Hanover is committed to providing programs and activities that reflect the needs and interests of our community. We invite you to take part in our Recreation Programming Survey to help us plan for the future.



<https://forms.gle/FpCW8MAR7gicJDtF6>

GRUNTHAL ARENA

SATURDAY 26TH APRIL, 2025

# ARENA RENEWAL FUNDRAISER



FOOD TRUCKS 5 PM

**DUKES  
DEXTERS  
AND MORE**

ENTERTAINMENT 6 PM

**MATT FALK  
THE DUMPSTER FIRES  
THE GOOD 'OL BOYS**



\$25/PERSON (12 & UNDER ARE FREE)

TICKETS AVAILABLE IN ADVANCE AT THE FOLLOWING LOCATIONS:  
GRUNTHAL LUMBER, GRUNTHAL GROCERY & RM OF HANOVER OFFICE

# FLAG FOOTBALL IS COMING TO OUR COMMUNITY!



# \$117

per athlete

- ✗ No experience required
- ✗ Open to ages 9-13
- ✗ U10, U12 & U14
- ✗ Boys and Girls

*Includes one Blue Bombers ticket to pre-season home game in 2025.*

**TO REGISTER & LEARN MORE, VISIT:  
[BLUEBOMBERS.COM/HANOVERFLAGFOOTBALL](http://BLUEBOMBERS.COM/HANOVERFLAGFOOTBALL)**

# W FLAG FOOTBALL

NIVERVILLE • RITCHOT • HANOVER

